

LINEA ROSSA LLC

LR-460 ALUMINUM FRENCH DOOR SYSTEM (HVHZ)(IMPACT)

GENERAL NOTES:

- THE PRODUCT SHOWN HEREIN IS DESIGNED AND MANUFACTURED TO COMPLY WITH THE CURRENT EDITION FLORIDA BUILDING CODE (FBC), **INCLUDING** HVHZ AND HAS BEEN EVALUATED ACCORDING TO THE FOLLOWING:
 - TAS 201-94
 - TAS 202-94
 - TAS 203-94
- ADEQUACY OF THE EXISTING STRUCTURAL CONCRETE/MASONRY, 2X FRAMING, AND METAL FRAMING AS A MAIN WIND FORCE RESISTING SYSTEM CAPABLE OF WITHSTANDING AND TRANSFERRING APPLIED PRODUCT LOADS TO THE FOUNDATION IS THE RESPONSIBILITY OF THE ENGINEER OR ARCHITECT OF RECORD FOR THE PROJECT OF INSTALLATION.
- 1X AND 2X BUCKS (WHEN USED) SHALL BE DESIGNED AND ANCHORED TO PROPERLY TRANSFER ALL LOADS TO THE STRUCTURE. BUCK DESIGN AND INSTALLATION IS THE RESPONSIBILITY OF THE ENGINEER OR ARCHITECT OF RECORD FOR THE PROJECT OF INSTALLATION.
- THE INSTALLATION DETAILS DESCRIBED HEREIN ARE GENERIC AND MAY NOT REFLECT ACTUAL CONDITIONS FOR A SPECIFIC SITE. IF SITE CONDITIONS CAUSE INSTALLATION TO DEVIATE FROM THE REQUIREMENTS DETAILED HEREIN, A LICENSED ENGINEER OR ARCHITECT SHALL PREPARE SITE SPECIFIC DOCUMENTS FOR USE WITH THIS DOCUMENT IN NON-HVHZ AREAS.
- APPROVED IMPACT PROTECTIVE SYSTEM **IS NOT REQUIRED** ON THIS PRODUCT IN AREAS REQUIRING IMPACT RESISTANCE.
- WINDOW FRAME MATERIAL: ALUMINUM 6063-T6
- GLASS MEETS THE REQUIREMENTS OF ASTM E 1300 GLASS CHARTS. SEE SHEET 1 FOR GLAZING DETAILS.

DOOR LEAF MAX. SIZE	DESIGN PRESSURE	HARDWARE	GLASS TYPE	MISSILE IMPACT RATING
47 1/8" x 118 1/8"	+/- 100 PSF	MULTI POINT W/ REINFORCEMENT	A, B, C, D	LARGE & SMALL MISSILE IMPACT
47 1/8" x 118 1/8"	+/- 100 PSF	PANIC W/ REINFORCEMENT	A, B, C, D	
42 1/16" x 94 1/16"	+/- 60 PSF	PANIC W/O REINFORCEMENT	A, B, C, D	

TABLE OF CONTENTS	
SHEET	SHEET DESCRIPTION
1	GENERAL NOTES & GLAZING DETAILS
2	ELEVATIONS & ANCHOR LAYOUTS - DOOR
3	ELEVATIONS & ANCHOR LAYOUTS - DOOR W/ TRANSOM
4	DOOR DESIGN PRESSURE TABLES
5	VERTICAL SECTIONS
6	VERTICAL SECTIONS
7	VERTICAL SECTIONS
8	HORIZONTAL SECTIONS
9	HARDWARE OPTIONS
10	INSTALLATION NOTES & ANCHOR DETAILS

TITLE: LR-460 ALUMINUM FRENCH DOOR SYSTEM (HVHZ)(IMPACT)

GENERAL NOTES & GLAZING DETAILS

PREPARED BY: BUILDING DROPS, INC.
398 E. DANIA BEACH BLVD., STE. 338
DANIA BEACH, FL 33004
PH: (954)399-8478
FAX: (954)744-4738
WEB: www.buildingdrops.com



REMARKS	BY	DATE

THE INSTALLATION DETAILS DESCRIBED HEREIN ARE GENERIC AND MAY NOT REFLECT ACTUAL CONDITIONS FOR A SPECIFIC SITE. IF SITE CONDITIONS CAUSE INSTALLATION TO DEVIATE FROM THE REQUIREMENTS DETAILED HEREIN, A LICENSED ENGINEER OR ARCHITECT SHALL PREPARE SITE SPECIFIC DOCUMENTS FOR USE WITH THIS DOCUMENT.

HERMES F. NORERO P.E.
FLORIDA P. E. NO. 73778
398 E. DANIA BEACH BLVD., STE. 338
DANIA BEACH, FL 33004
FBPE CERT. OF AUTHORIZATION NO. 29578

FL38501

DATE: 10.06.2023	
DWG. BY: SH	CHK. BY: HFN
SCALE: NTS	
DWG. #: LRA013	
SHEET: 1	OF 10

GLAZING NOTES:

- GLASS TYPE COMPLIES WITH ASTM E1300 REQUIREMENTS AS WELL AS APPLICABLE SAFETY GLAZING REQUIREMENTS PER THE FBC. TEMPER AND SAFETY GLAZING REQUIREMENTS SHALL BE REVIEWED ON A SITE SPECIFIC BASIS.
- SETTING BLOCK DUROMETER HARDNESS OF 70-90 (SHORE A) AS REFERENCED IN FBC CHAPTER 24.
- TWO APPROVED SETTING BLOCKS SHALL BE USED FOR GLASS WIDER THAN 36" AS PER FBC CHAPTER 24.
- D.L.O. AND DESIGN PRESSURES MAY NOT EXCEED MAX VALUES IN DP TABLE ON SHEET 1, AND ELEVATIONS ON SHEET 2 & 3.

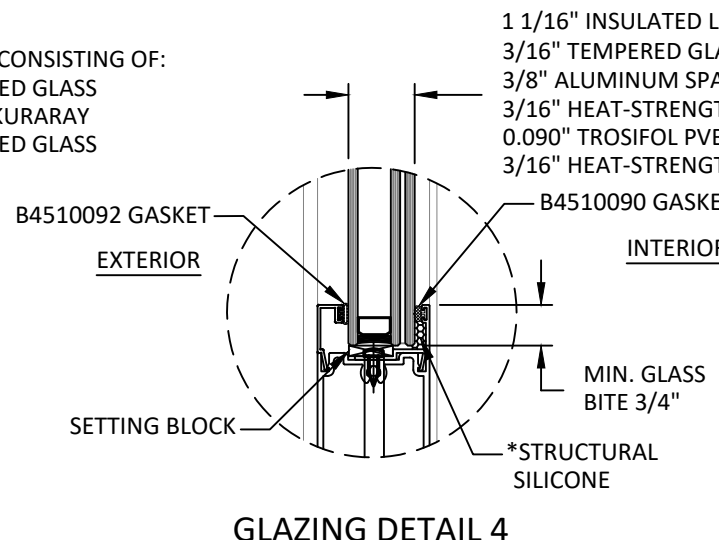
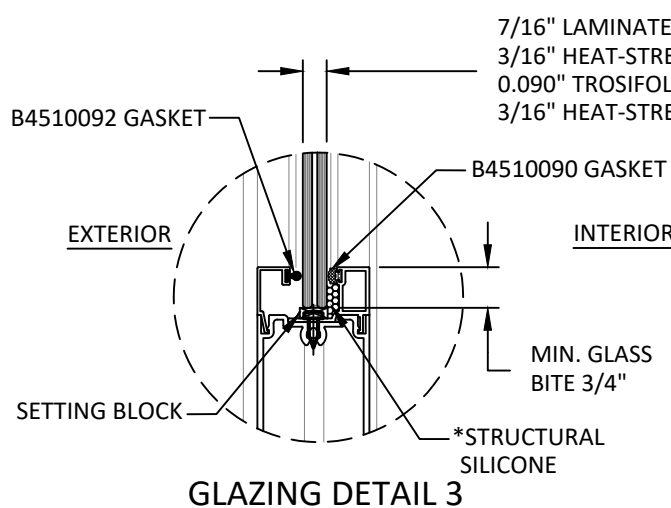
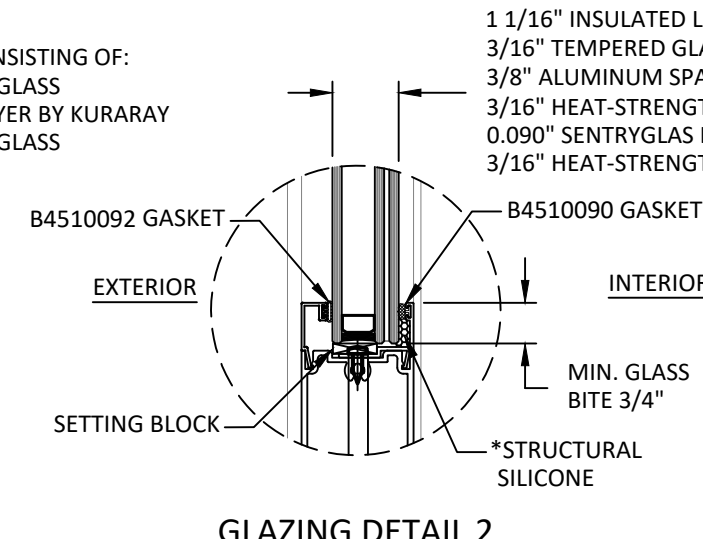
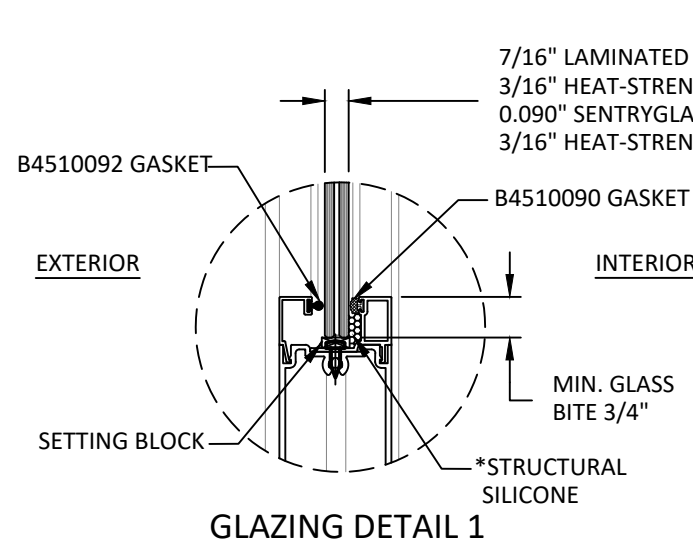

***APPROVED STRUCTURAL SILICONE:**

DOWSIL - 993
DOWSIL - 983
DOWSIL - 895
DOWSIL - 795

NO. OF CLUSTERED ANCHORS AT VERTICAL MULL ENDS		
SUBSTRATE TYPE	3/8" SHIM SPACE	1/2" SHIM SPACE
A	10	11
B	7	8
C	8	8
D	8	8

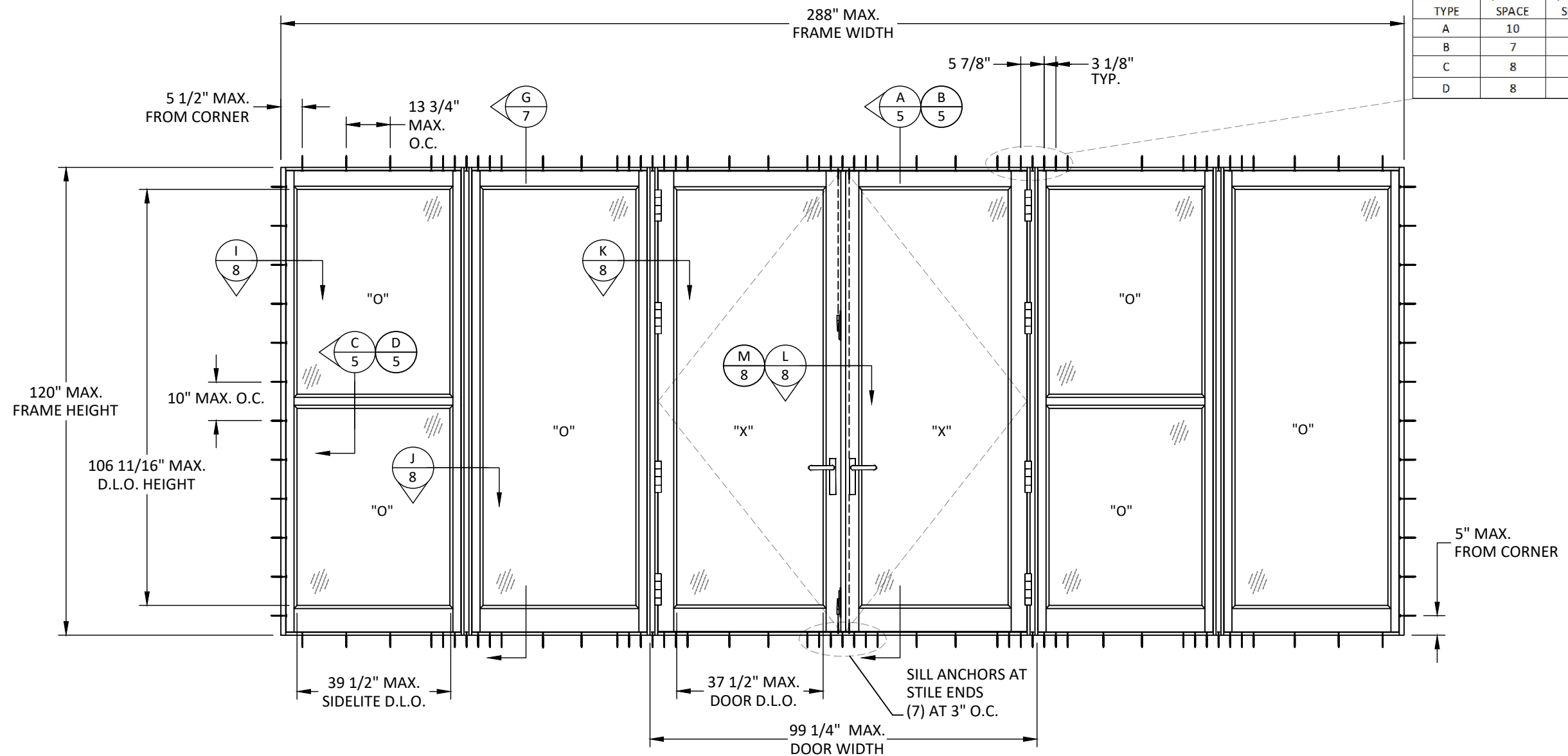

ELEVATION & ANCHOR LAYOUT
FRENCH DOOR

ADDITIONAL APPROVED CONFIGURATIONS

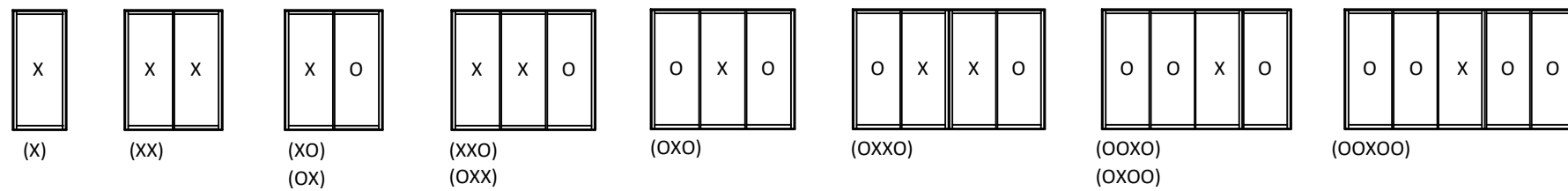

TITLE: LR-460 ALUMINUM FRENCH DOOR SYSTEM (HVHZ)(IMPACT)
ELEVATION AND ANCHOR LAYOUT - DOOR

PREPARED BY: BUILDING DROPS, INC.
398 E. DANIA BEACH BLVD., STE. 338
DANIA BEACH, FL 33004
PH: (954)399-8478
FAX: (954)744-4738
WEB: www.buildingdrops.com



REMARKS	BY	DATE

THE INSTALLATION DETAILS DESCRIBED HEREIN ARE GENERIC AND MAY NOT REFLECT ACTUAL CONDITIONS FOR A SPECIFIC SITE. IF SITE CONDITIONS CAUSE INSTALLATION TO DEVIATE FROM THE REQUIREMENTS DETAILED HEREIN, A LICENSED ENGINEER OR ARCHITECT SHALL PREPARE SITE SPECIFIC DOCUMENTS FOR USE WITH THIS DOCUMENT.

HERMES F. NORERO P.E.
FLORIDA P. E. NO. 73778
398 E. DANIA BEACH BLVD., STE. 338
DANIA BEACH, FL 33004
FBPE CERT. OF AUTHORIZATION NO. 29578

FL38501

DATE: 10.06.2023

DWG. BY: SH
CHK. BY: HFN

SCALE: NTS

DWG. #: LRA013

SHEET: OF 10

NO. OF CLUSTERED ANCHORS AT HORIZONTAL MULL ENDS		
SUBSTRATE TYPE	3/8" SHIM SPACE	1/2" SHIM SPACE
A	4	5
B	4	4
C	4	4
D	4	4

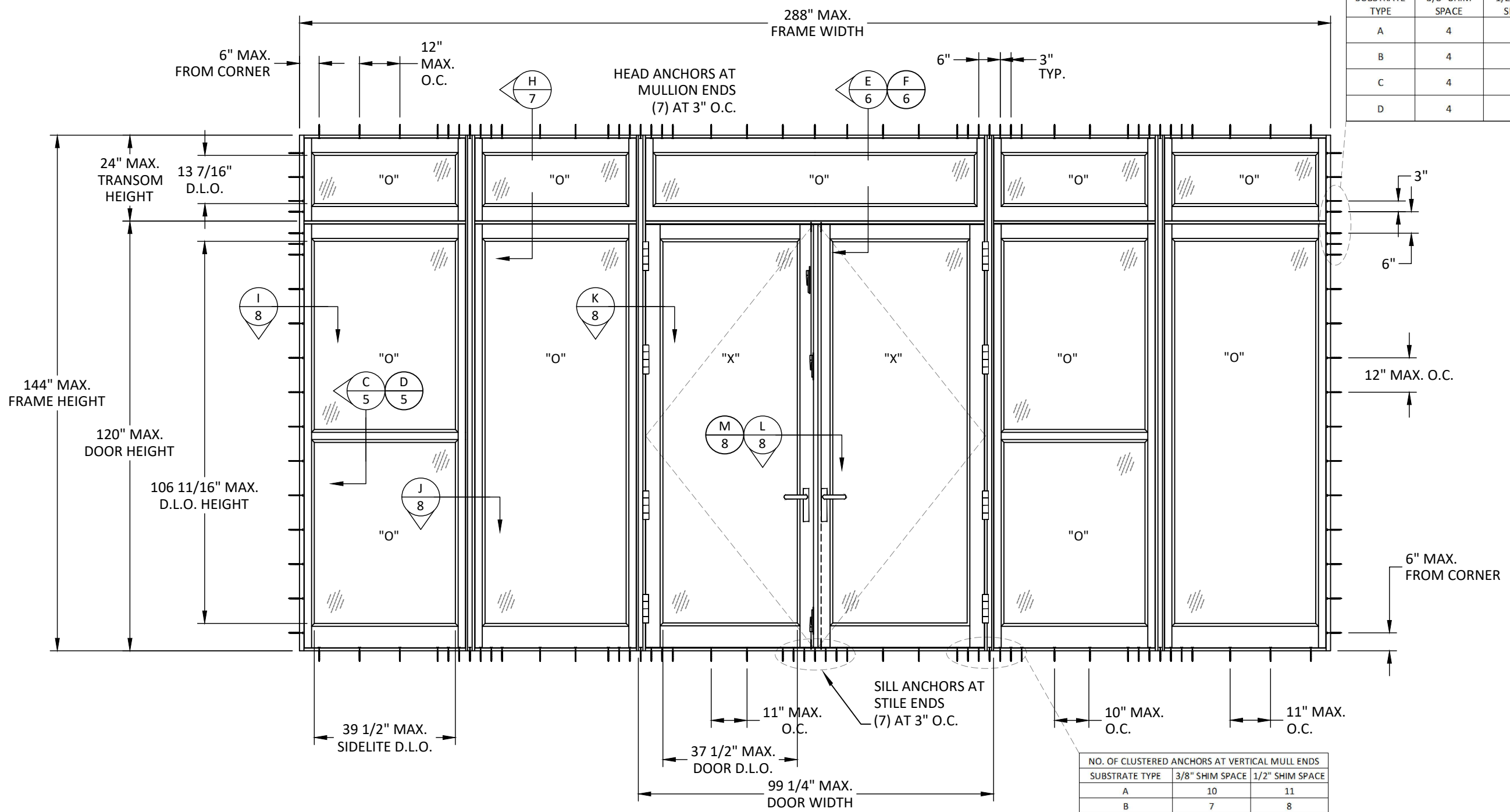

NO. OF CLUSTERED ANCHORS AT VERTICAL MULL ENDS		
SUBSTRATE TYPE	3/8" SHIM SPACE	1/2" SHIM SPACE
A	10	11
B	7	8
C	8	8
D	8	8

ELEVATION & ANCHOR LAYOUT
FRENCH DOOR W/ TRANSMOM

ADDITIONAL APPROVED CONFIGURATIONS

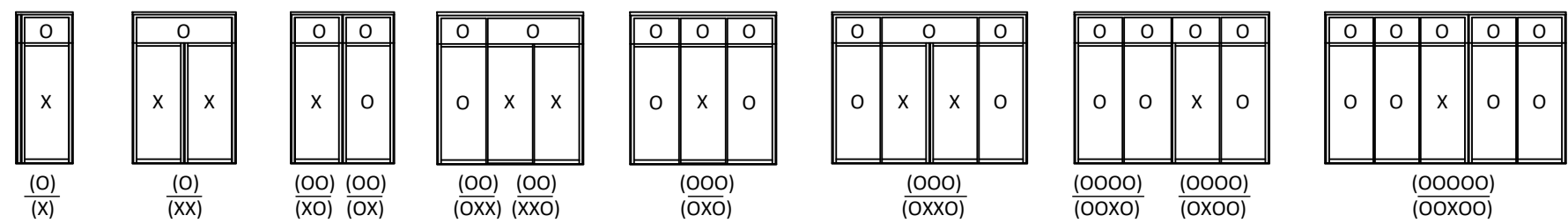

TITLE: LR-460 ALUMINUM FRENCH DOOR SYSTEM (HVHZ)(IMPACT) ELEVATION AND ANCHOR LAYOUT - DOOR WITH TRANSMOM

PREPARED BY: BUILDING DROPS, INC.
398 E. DANIA BEACH BLVD., STE. 338
DANIA BEACH, FL 33004
PH: (954)399-8478
FAX: (954)744-4738
WEB: www.buildingdrops.com

REMARKS	BY	DATE

THE INSTALLATION DETAILS DESCRIBED HEREIN ARE GENERIC AND MAY NOT REFLECT ACTUAL CONDITIONS FOR A SPECIFIC SITE. IF SITE CONDITIONS CAUSE INSTALLATION TO DEVIATE FROM THE REQUIREMENTS DETAILED HEREIN, A LICENSED ENGINEER OR ARCHITECT SHALL PREPARE SITE SPECIFIC DOCUMENTS FOR USE WITH THIS DOCUMENT.

HERMES F. NORERO P.E.
FLORIDA P. E. NO. 73778
398 E. DANIA BEACH BLVD., STE. 338
DANIA BEACH, FL 33004
FBPE CERT. OF AUTHORIZATION NO. 29578

FL38501

DATE: 10.06.2023

DWG. BY: SH CHK. BY: HFN

SCALE: NTS

DWG. #: LRA013

SHEET: OF 10

DESIGN PRESSURE TABLE
DOOR W/ ASTRAGAL REINFORCEMENT

DESIGN PRESSURE TABLE (+/- PSF)			
DOOR DIMENSIONS		WITH REINFORCEMENT	
LEAF WIDTH (IN.)	LEAF HEIGHT (IN.)		
29.125	82.125	100.0	
35.125		100.0	
41.125		100.0	
47.125		100.0	
53.125		100.0	
59.125		100.0	
65.125		100.0	
29.125	88.125	100.0	
35.125		100.0	
41.125		100.0	
47.125		100.0	
53.125		100.0	
59.125		100.0	
29.125		94.125	100.0
35.125	100.0		
41.125	100.0		
47.125	100.0		
53.125	100.0		
59.125	100.0		
29.125	100.125		100.0
35.125		100.0	
41.125		100.0	
47.125		100.0	
53.125		100.0	
29.125		106.125	100.0
35.125			100.0
41.125	100.0		
47.125	100.0		
29.125	112.125		100.0
35.125			100.0
41.125			100.0
47.125		100.0	
29.125		118.125	100.0
35.125			100.0
41.125			100.0
47.125	100.0		

NOTE: SEE DETAILS L/8 & M/8 FOR REINFORCEMENT DETAILS.

NOTE: INACTIVE DOOR LEAF WIDTH SIZES TO BE BETWEEN 12" AND 49 3/4".

DESIGN PRESSURE TABLE
DOOR W/O ASTRAGAL REINFORCEMENT

DESIGN PRESSURE TABLE (+/- PSF)		
DOOR DIMENSIONS		WITHOUT REINFORCEMENT
LEAF WIDTH (IN.)	LEAF HEIGHT (IN.)	
24.0625	70.0625	60.0
30.0625		60.0
36.0625		60.0
42.0625		60.0
48.0625		60.0
54.0625		60.0
24.0625		76.0625
30.0625	60.0	
36.0625	60.0	
42.0625	60.0	
48.0625	60.0	
54.0625	60.0	
24.0625	82.0625	
30.0625		60.0
36.0625		60.0
42.0625		60.0
48.0625		60.0
54.0625		60.0
24.0625		88.0625
30.0625	60.0	
36.0625	60.0	
42.0625	60.0	
48.0625	60.0	
54.0625	60.0	
24.0625	94.0625	
30.0625		60.0
36.0625		60.0
42.0625		60.0

TITLE: LR-460 ALUMINUM FRENCH DOOR SYSTEM (HVHZ)(IMPACT)
DOOR DESIGN PRESSURE TABLES

PREPARED BY: BUILDING DROPS, INC.
398 E. DANIA BEACH BLVD., STE. 338
DANIA BEACH, FL 33004
PH: (954)399-8478
FAX: (954)744-4738
WEB: www.buildingdrops.com



REMARKS	BY	DATE

THE INSTALLATION DETAILS DESCRIBED HEREIN ARE GENERIC AND MAY NOT REFLECT ACTUAL CONDITIONS FOR A SPECIFIC SITE. IF SITE CONDITIONS CAUSE INSTALLATION TO DEVIATE FROM THE REQUIREMENTS DETAILED HEREIN, A LICENSED ENGINEER OR ARCHITECT SHALL PREPARE SITE SPECIFIC DOCUMENTS FOR USE WITH THIS DOCUMENT.

HERMES F. NORERO P.E.
FLORIDA P. E. NO. 73778
398 E. DANIA BEACH BLVD., STE. 338
DANIA BEACH, FL 33004
FBPE CERT. OF AUTHORIZATION NO. 29578

FL38501	
DATE: 10.06.2023	
DWG. BY: SH	CHK. BY: HFN
SCALE: NTS	
DWG. #: LRA013	
SHEET:	OF 10

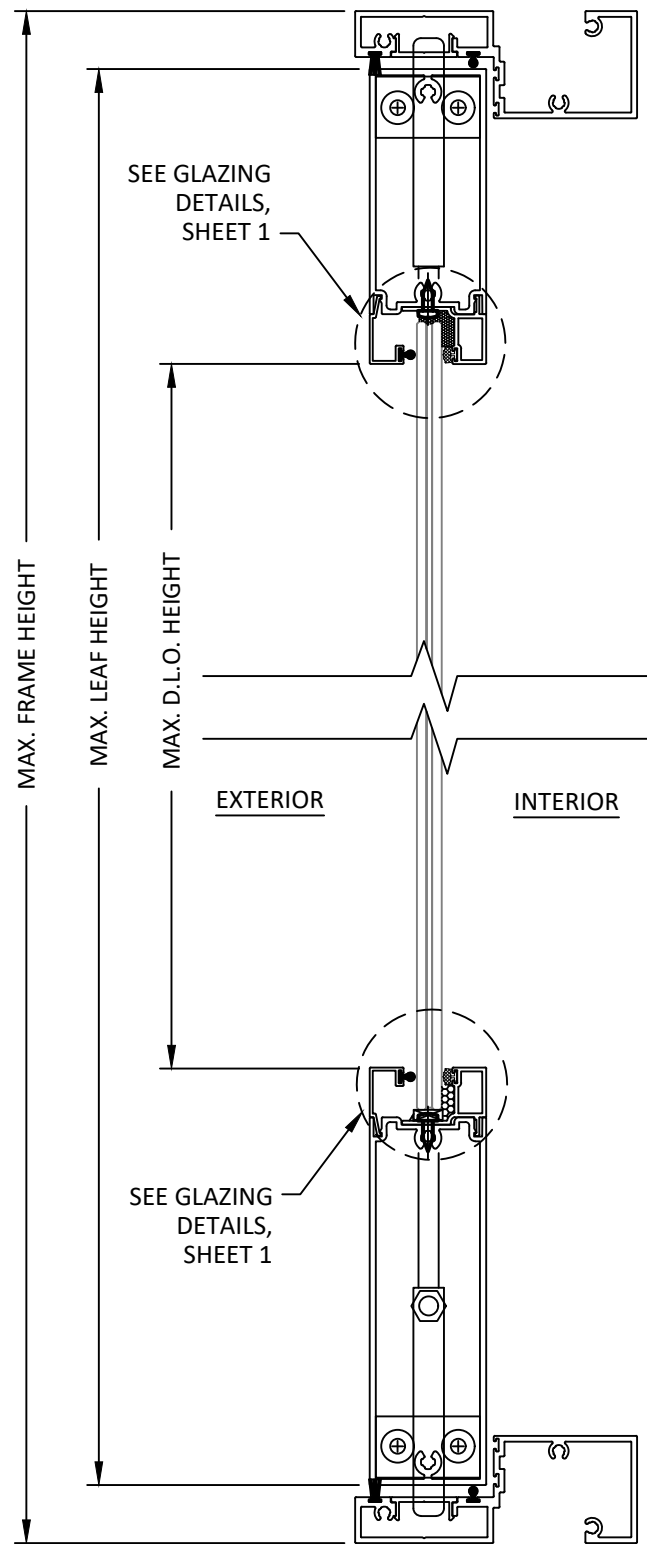

A
5

VERTICAL SECTION

DOOR - WITH WATER SILL
LAMINATED GLASS

NOTE: WATER SILL RATED FOR WATER INFILTRATION UP TO A POSITIVE DESIGN PRESSURE OF +100 PSF.

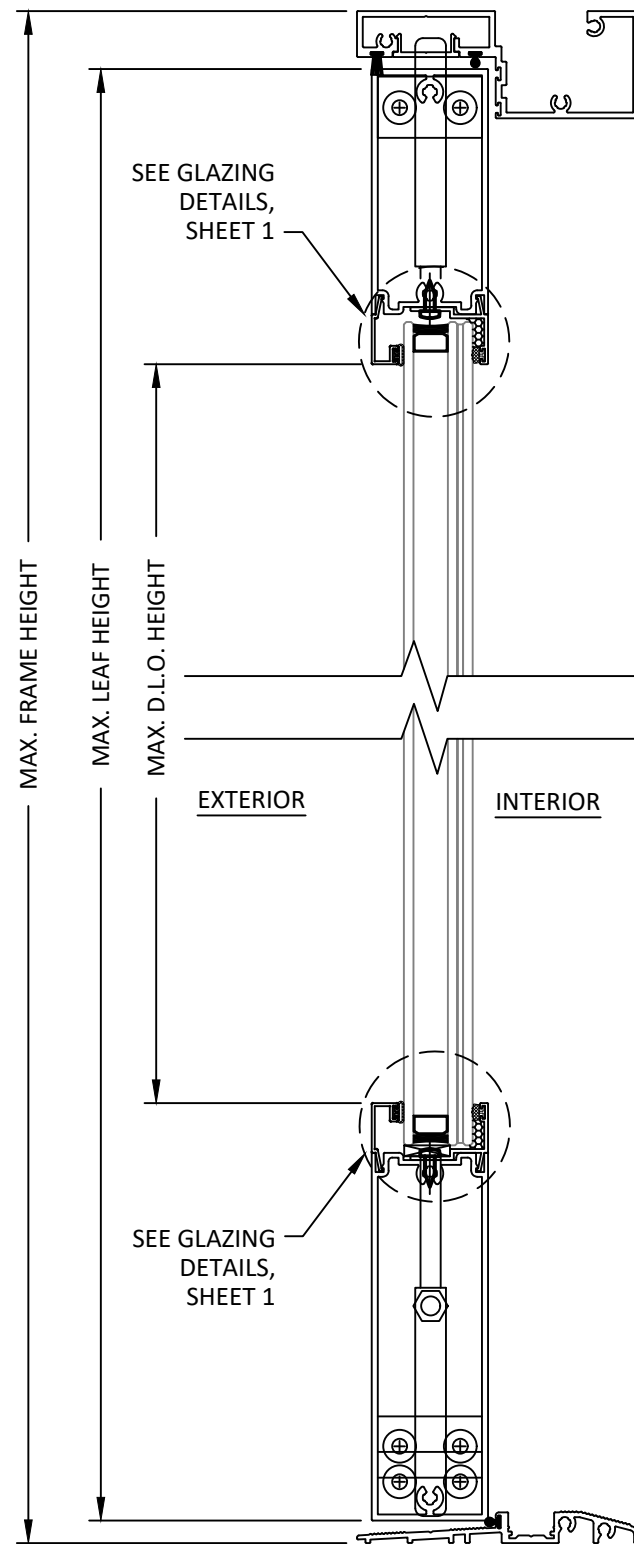

B
5

VERTICAL SECTION

DOOR - WITH ADA TRESHOLD
INSULATED GLASS

NOTE: ADA SILL RATED FOR WATER INFILTRATION UP TO A POSITIVE DESIGN PRESSURE OF +60 PSF.

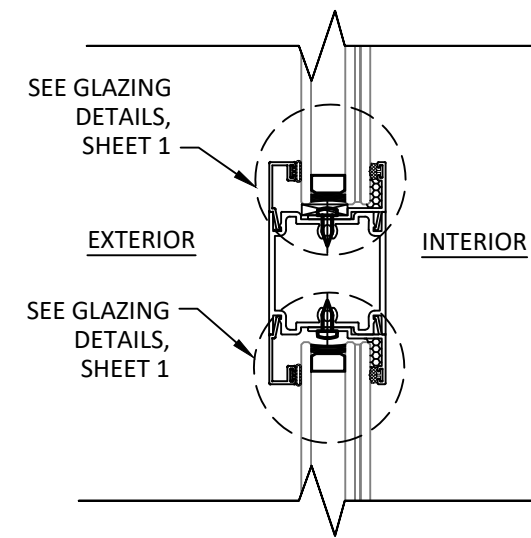

D
5

VERTICAL SECTION

DOOR - MIDRAIL
INSULATED GLASS

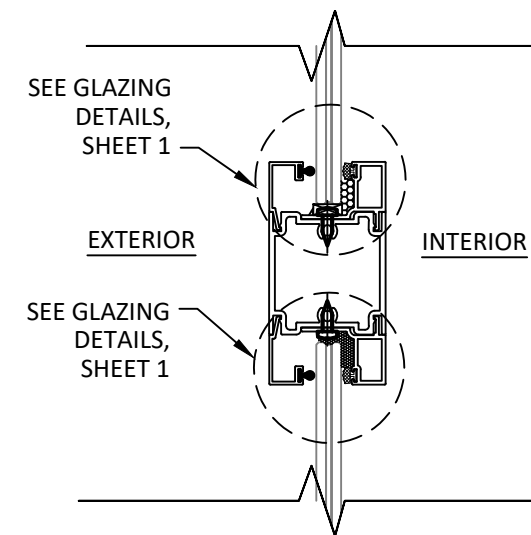

C
5

VERTICAL SECTION

DOOR - MIDRAIL
LAMINATED GLASS

LINEA ROSSA®
WINDOWS & DOORS

1850 NW. 84TH AVE., STE. 114
DORAL, FL 33126
PH: (305)815-8797

TITLE: LR-460 ALUMINUM FRENCH
DOOR SYSTEM
(HVHZ)(IMPACT)
VERTICAL SECTIONS

PREPARED BY: BUILDING DROPS, INC.
398 E. DANIA BEACH BLVD., STE. 338
DANIA BEACH, FL 33004
PH: (954)399-8478
FAX: (954)744-4738
WEB: www.buildingdrops.com



REMARKS	BY	DATE

THE INSTALLATION DETAILS DESCRIBED HEREIN ARE GENERIC AND MAY NOT REFLECT ACTUAL CONDITIONS FOR A SPECIFIC SITE. IF SITE CONDITIONS CAUSE INSTALLATION TO DEVIATE FROM THE REQUIREMENTS DETAILED HEREIN, A LICENSED ENGINEER OR ARCHITECT SHALL PREPARE SITE SPECIFIC DOCUMENTS FOR USE WITH THIS DOCUMENT.

HERMES F. NORERO P.E.
FLORIDA P. E. NO. 73778
398 E. DANIA BEACH BLVD., STE. 338
DANIA BEACH, FL 33004
FBPE CERT. OF AUTHORIZATION NO. 29578

FL38501

DATE: 10.06.2023

DWG. BY: SH CHK. BY: HFN

SCALE: NTS

DWG. #: LRA013

SHEET: 5 OF 10

5

TITLE: LR-460 ALUMINUM FRENCH
DOOR SYSTEM
(HVHZ)(IMPACT)
VERTICAL SECTIONS

PREPARED BY: BUILDING DROPS, INC.
398 E. DANIA BEACH BLVD., STE. 338
DANIA BEACH, FL 33004
PH: (954)399-8478
FAX: (954)744-4738
WEB: www.buildingdrops.com



REMARKS	BY	DATE

THE INSTALLATION DETAILS DESCRIBED HEREIN ARE GENERIC AND MAY NOT REFLECT ACTUAL CONDITIONS FOR A SPECIFIC SITE. IF SITE CONDITIONS CAUSE INSTALLATION TO DEVIATE FROM THE REQUIREMENTS DETAILED HEREIN, A LICENSED ENGINEER OR ARCHITECT SHALL PREPARE SITE SPECIFIC DOCUMENTS FOR USE WITH THIS DOCUMENT.

HERMES F. NORERO P.E.
FLORIDA P. E. NO. 73778
398 E. DANIA BEACH BLVD., STE. 338
DANIA BEACH, FL 33004
FBPE CERT. OF AUTHORIZATION NO. 29578

FL38501

DATE: 10.06.2023

DWG. BY: SH	CHK. BY: HFN
----------------	-----------------

SCALE: NTS

DWG. #: LRA013

SHEET: 7 OF 10

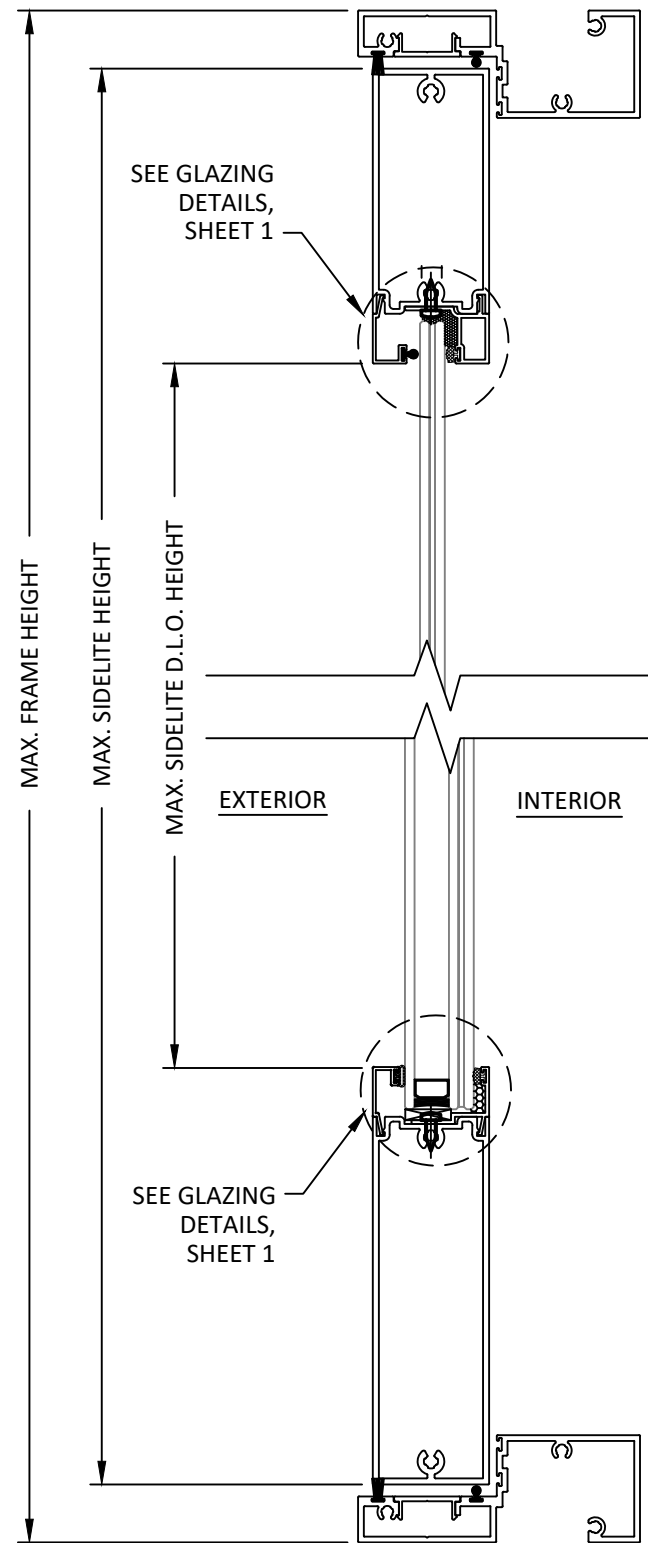

G
7

VERTICAL SECTION

SIDE LITE
INSULATED GLASS (SILL) - LAMINATED GLASS (HEAD)

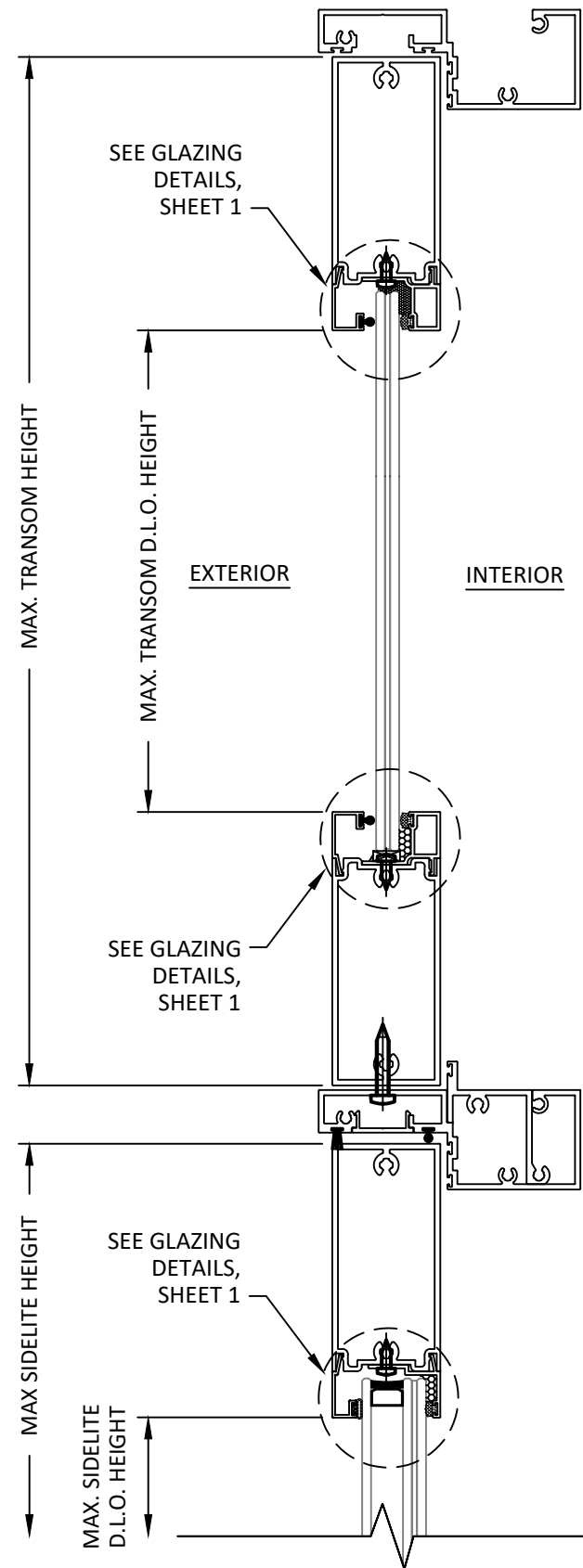

H
7

VERTICAL SECTION

SIDELITE WITH TRANSOM

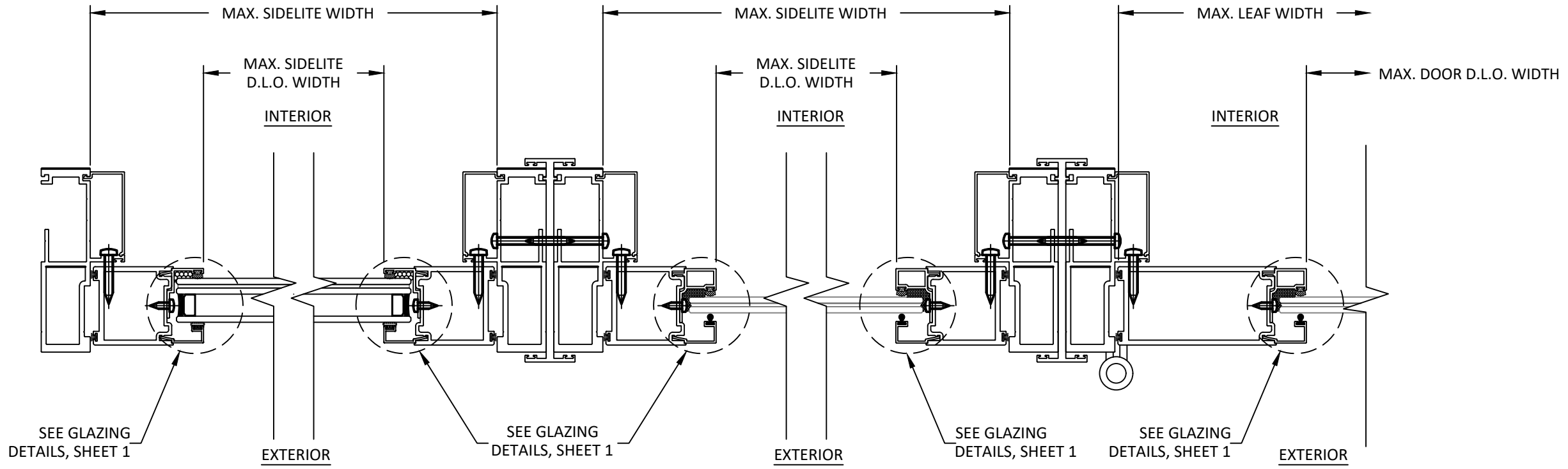

I
8 HORIZONTAL SECTION
SIDELITE JAMB

J
8 HORIZONTAL SECTION
SIDELITE TO SIDELITE

K
8 HORIZONTAL SECTION
SIDELITE TO DOOR

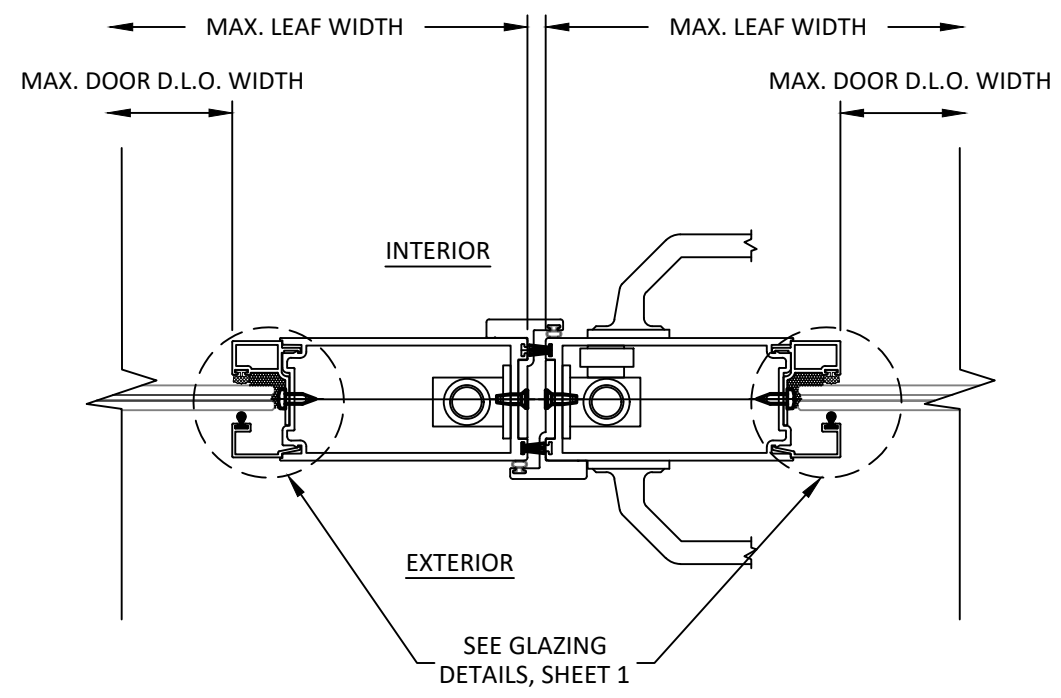

L
8 HORIZONTAL SECTION
ASTRAGAL W/O REINFORCEMENT

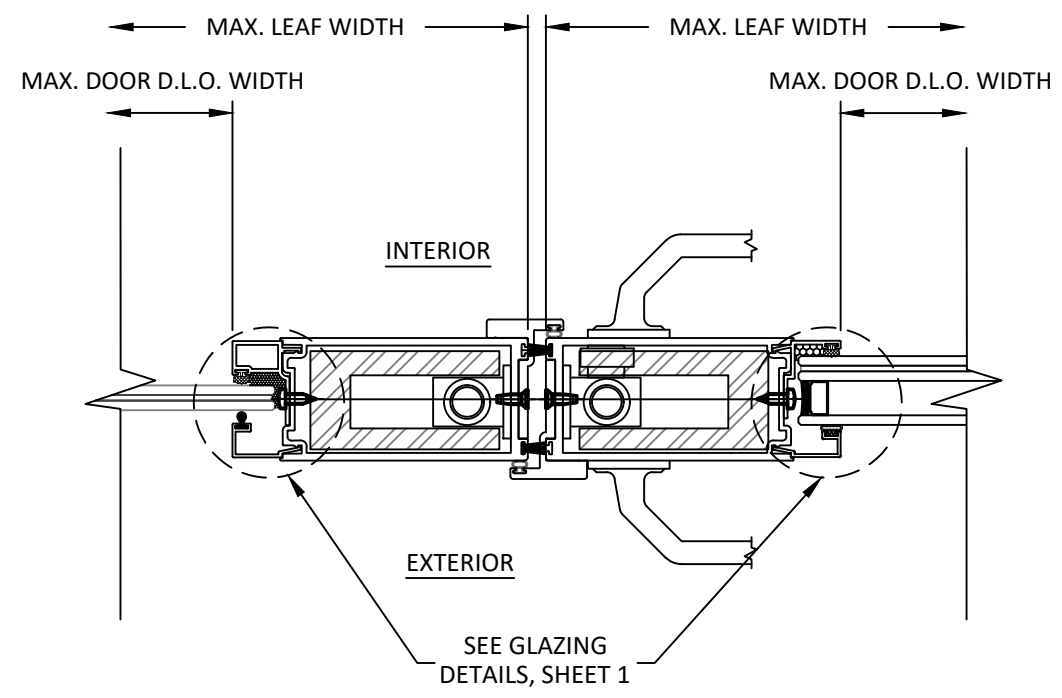

M
8 HORIZONTAL SECTION
ASTRAGAL WITH REINFORCEMENT

TITLE: LR-460 ALUMINUM FRENCH
DOOR SYSTEM
(HVHZ)(IMPACT)
HORIZONTAL SECTIONS

PREPARED BY: BUILDING DROPS, INC.
398 E. DANIA BEACH BLVD., STE. 338
DANIA BEACH, FL 33004
PH: (954)399-8478
FAX: (954)744-4738
WEB: www.buildingdrops.com



REMARKS	BY	DATE

THE INSTALLATION DETAILS DESCRIBED HEREIN ARE GENERIC AND MAY NOT REFLECT ACTUAL CONDITIONS FOR A SPECIFIC SITE. IF SITE CONDITIONS CAUSE INSTALLATION TO DEVIATE FROM THE REQUIREMENTS DETAILED HEREIN, A LICENSED ENGINEER OR ARCHITECT SHALL PREPARE SITE SPECIFIC DOCUMENTS FOR USE WITH THIS DOCUMENT.

HERMES F. NORERO P.E.
FLORIDA P. E. NO. 73778
398 E. DANIA BEACH BLVD., STE. 338
DANIA BEACH, FL 33004
FBPE CERT. OF AUTHORIZATION NO. 29578

FL38501

DATE: 10.06.2023

DWG. BY: SH	CHK. BY: HFN
-----------------------	------------------------

SCALE: NTS

DWG. #: LRA013

SHEET: OF 10

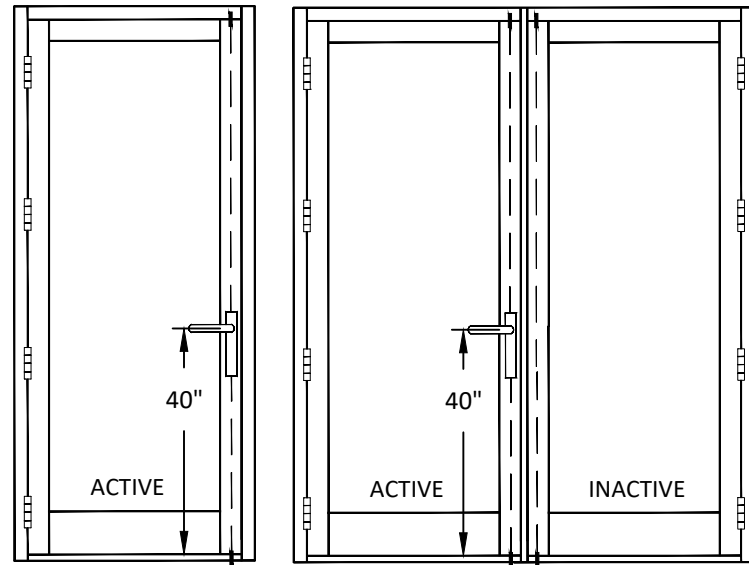

LOCK OPTION #1:

ACTIVE LEAF

4- POINT LOCK OPTIMUM SYSTEM (B7380001) BY INTERLOCK AT 40" FROM BOTTOM HANDLE ACTIVATES DEAD BOLTS AND SHOOT BOLTS ENGAGING AT HEAD AND SILL
KEY OPERATED ON EXTERIOR AND THUMB TURN ON INTERIOR

INACTIVE LEAF

PASSIVE WINGLOCK B6270050 AT TOP & BOTTOM OF DOOR
ACTIVATES SHOOT BOLTS ENGAGING AT HEAD AND SILL

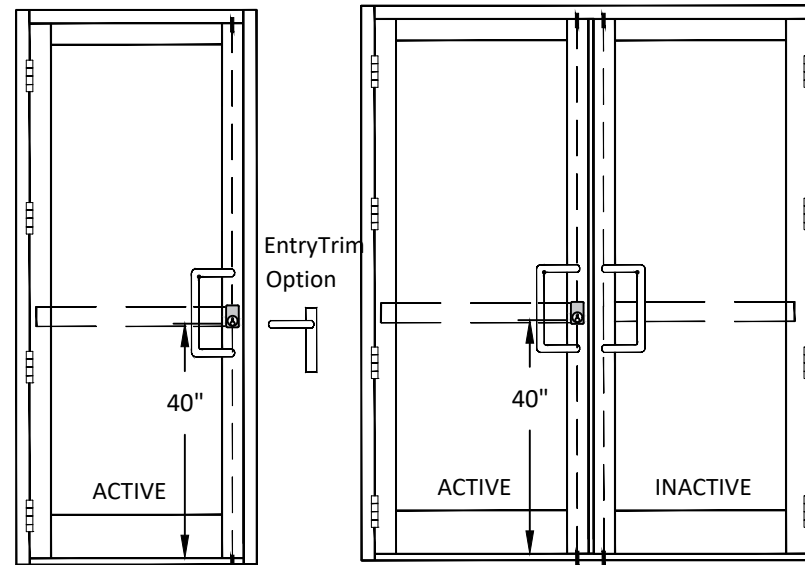

LOCK OPTION #3:

ACTIVE AND INACTIVE LEAF

SUFACE VERTICAL ROD PANIC EXIT DEVICE BY VON DUPRIN
LOCATED AT 40" FROM SILL AT EACH LEAF

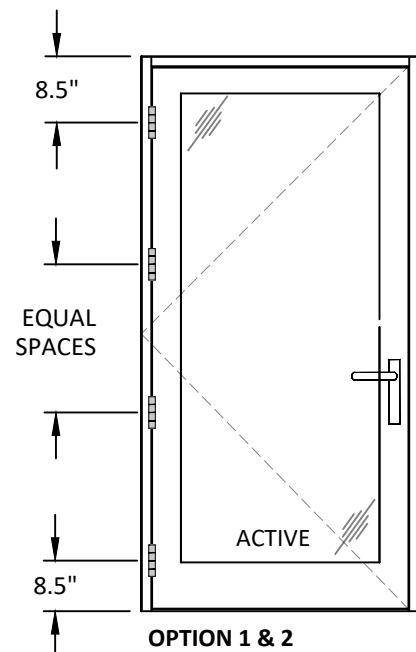

HINGE OPTIONS

HINGE OPTION #1:

BUTT HINGE BY DORMA 3094F (3) PER LEAF UP TO 96" F.H.
@ 8 1/2" FROM HEAD AND SILL AND (2) EQUAL SPACES.

HINGE OPTION #2:

BUTT HINGE BY DORMA 3094F (4) PER LEAF FROM 96" TO
120" F.H. @ 8 1/2" FROM HEAD AND SILL AND (3) EQUAL SPACES.

TITLE: LR-460 ALUMINUM FRENCH
DOOR SYSTEM
(HVHZ)(IMPACT)
HARDWARE OPTIONS

PREPARED BY: BUILDING DROPS, INC.
398 E. DANIA BEACH BLVD., STE. 338
DANIA BEACH, FL 33004
PH: (954)399-8478
FAX: (954)744-4738
WEB: www.buildingdrops.com



REMARKS	BY	DATE

THE INSTALLATION DETAILS DESCRIBED HEREIN ARE GENERIC AND MAY NOT REFLECT ACTUAL CONDITIONS FOR A SPECIFIC SITE. IF SITE CONDITIONS CAUSE INSTALLATION TO DEVIATE FROM THE REQUIREMENTS DETAILED HEREIN, A LICENSED ENGINEER OR ARCHITECT SHALL PREPARE SITE SPECIFIC DOCUMENTS FOR USE WITH THIS DOCUMENT.

HERMES F. NORERO P.E.
FLORIDA P. E. NO. 73778
398 E. DANIA BEACH BLVD., STE. 338
DANIA BEACH, FL 33004
FBPE CERT. OF AUTHORIZATION NO. 29578

FL38501

DATE: 10.06.2023

DWG. BY: SH	CHK. BY: HFN
----------------	-----------------

SCALE: NTS

DWG. #: LRA013

SHEET: 9 OF 10

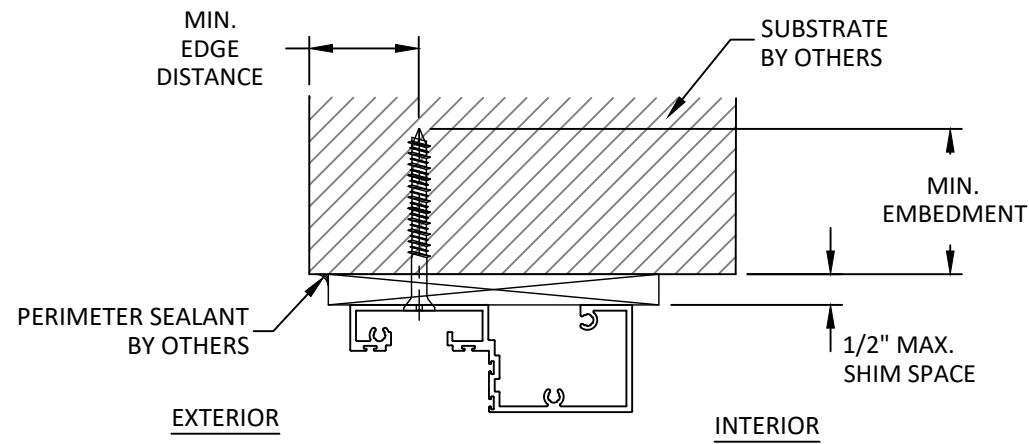

A
10 ANCHOR DETAIL
THROUGH FRAME (HEAD)

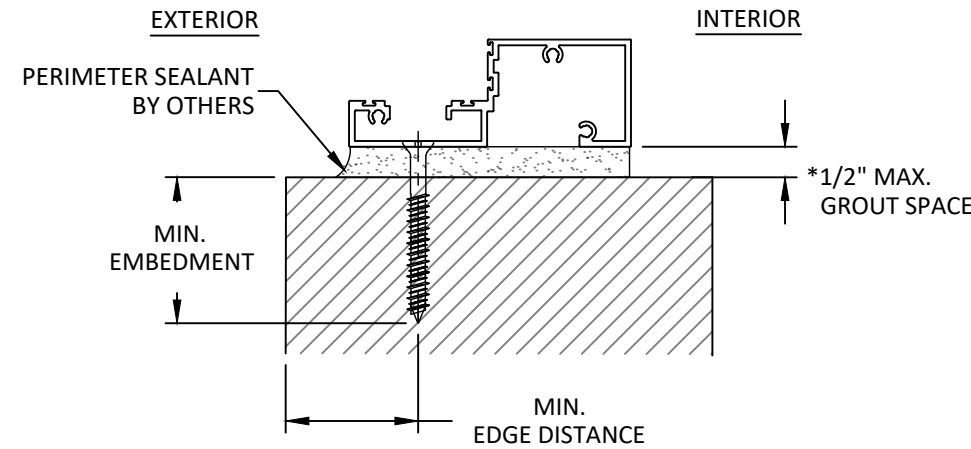

B
10 ANCHOR DETAIL
THROUGH FRAME SILL

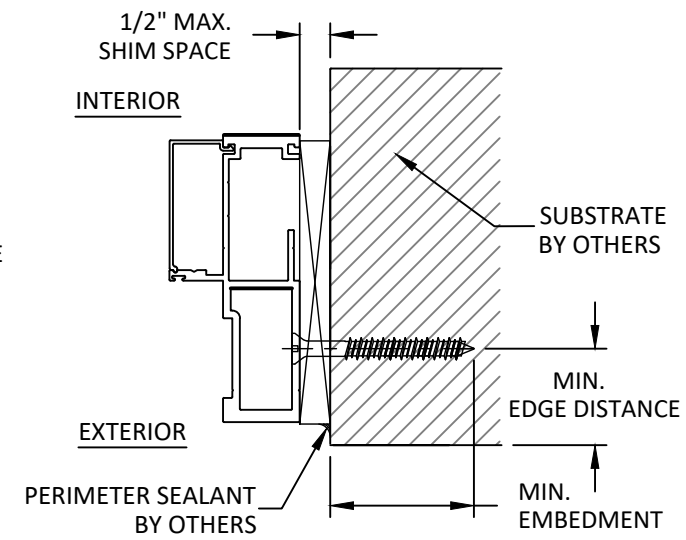

C
10 ANCHOR DETAIL
THROUGH FRAME (JAMB)

* POUR & HARDENED HIGH STRENGTH GROUT
NON-SHRINK, NON-METALIC f'c = 5000 PSI MIN.
NOT BY MANUFACTURE WINDOW COMPANY.
MUST TRANSFER SHEAR LOADS TO STRUCTURE.

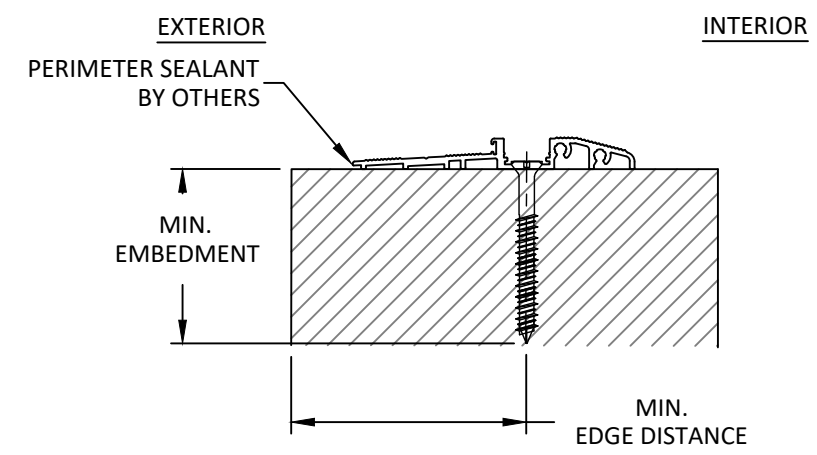

D
10 ANCHOR DETAIL
ADA THROUGH FRAME SILL

INSTALLATION NOTES:

- ONE (1) INSTALLATION ANCHOR IS REQUIRED AT EACH ANCHOR LOCATION SHOWN.
- THE NUMBER OF INSTALLATION ANCHORS DEPICTED IS THE MINIMUM NUMBER OF ANCHORS TO BE USED FOR PRODUCT INSTALLATION OF THE MAXIMUM SIZE LISTED.
- INSTALL INDIVIDUAL INSTALLATION ANCHORS WITHIN A TOLERANCE OF $\pm 1/2$ INCH THE DEPICTED LOCATION & SPACING IN THE ANCHOR LAYOUT DETAILS (I.E., WITHOUT CONSIDERATION OF TOLERANCES). TOLERANCES ARE NOT CUMULATIVE FROM ONE INSTALLATION ANCHOR TO THE NEXT.
- SHIM AS REQUIRED AT EACH INSTALLATION ANCHOR WITH LOAD BEARING SHIM(S). MAXIMUM ALLOWABLE SHIM STACK TO BE 1/2" INCH. SHIM WHERE SPACE OF 1/16 INCH OR GREATER OCCURS. SHIM(S) SHALL BE CONSTRUCTED OF HIGH DENSITY PLASTIC OR BETTER.
- FOR MASONRY OR CONCRETE OPENINGS, 1X WOOD BUCK MAY BE USED (OPTIONAL AS LONG AS THE MINIMUM EMBEDMENT AND EDGE DISTANCE REQUIREMENTS ARE STILL MET WITHIN THE CORRESPONDING HOST SUBSTRATE. SEE GENERAL NOTE #3 ON SHEET 1 FOR MORE INFORMATION.
- MINIMUM EMBEDMENT AND EDGE DISTANCE EXCLUDE WALL FINISHES, INCLUDING BUT NOT LIMITED TO STUCCO, FOAM, BRICK VENEER, AND SIDING.
- INSTALLATION ANCHORS AND ASSOCIATED HARDWARE MUST BE MADE OF CORROSION RESISTANT MATERIAL OR HAVE A CORROSION RESISTANT COATING.
- FOR HOLLOW BLOCK AND GROUT FILLED BLOCK, DO NOT INSTALL INSTALLATION ANCHORS INTO MORTAR JOINTS. EDGE DISTANCE IS MEASURED FROM FREE EDGE OF BLOCK OR EDGE OF MORTAR JOINT INTO FACE SHELL OF BLOCK.
- INSTALLATION ANCHORS SHALL BE INSTALLED IN ACCORDANCE WITH ANCHOR MANUFACTURER'S INSTALLATION INSTRUCTIONS, AND ANCHORS SHALL NOT BE USED IN SUBSTRATES WITH STRENGTHS LESS THAN THE MINIMUM STRENGTH SPECIFIED BY THE ANCHOR MANUFACTURER.

ANCHOR SCHEDULE					
METHOD	SUBSTRATE TYPE	SUBSTRATE	ANCHOR TYPE	MIN EMBEDMENT	MIN. EDGE DISTANCE
THROUGH FRAME	A	WOOD: MIN. SG = 0.55	5 / 16" DEWALT ULTRACON	1.50"	1.00"
	B	METAL: 18 GAUGE STEEL, MIN. Fy = 33KSI ALUMINUM 6063-T5 0.125 MIN	1 / 4" DEWALT DRILL-FLEX	3 THREADS MIN. PENETRATION BEYOND METAL	0.75"
	C	CONCRETE: f'c=3000PSI	5 / 16" DEWALT ULTRACON	1.75"	2.50"
	D	MASONRY: CMU per ASTM C90 MIN. 2000 PSI	5 / 16" DEWALT ULTRACON	1.25"	2.50"

TITLE: LR-460 ALUMINUM FRENCH DOOR SYSTEM (HVHZ)(IMPACT)
INSTALLATION NOTES & ANCHOR DETAILS
PREPARED BY: BUILDING DROPS, INC.
398 E. DANIA BEACH BLVD., STE. 338
DANIA BEACH, FL 33004
PH: (954)399-8478
FAX: (954)744-4738
WEB: www.buildingdrops.com

REMARKS	BY	DATE

THE INSTALLATION DETAILS DESCRIBED HEREIN ARE GENERIC AND MAY NOT REFLECT ACTUAL CONDITIONS FOR A SPECIFIC SITE. IF SITE CONDITIONS CAUSE INSTALLATION TO DEVIATE FROM THE REQUIREMENTS DETAILED HEREIN, A LICENSED ENGINEER OR ARCHITECT SHALL PREPARE SITE SPECIFIC DOCUMENTS FOR USE WITH THIS DOCUMENT.

HERMES F. NORERO P.E.
FLORIDA P. E. NO. 73778
398 E. DANIA BEACH BLVD., STE. 338
DANIA BEACH, FL 33004
FBPE CERT. OF AUTHORIZATION NO. 29578

FL38501

DATE: 10.06.2023

DWG. BY: SH
CHK. BY: HFN

SCALE: NTS

DWG. #: LRA013

SHEET: OF 10