

LINEA ROSSA LLC

LR-420 ALUMINUM OUTSWING CASEMENT WINDOW (HVHZ)(IMPACT)

LINEA ROSSA
WINDOWS & DOORS

1850 NW. 84TH AVE., STE. 114
DORAL, FL 33126
PH: (305)815-8797

GENERAL NOTES:

- THE PRODUCT SHOWN HEREIN IS DESIGNED AND MANUFACTURED TO COMPLY WITH THE CURRENT EDITION FLORIDA BUILDING CODE (FBC), **INCLUDING** HVHZ AND HAS BEEN EVALUATED ACCORDING TO THE FOLLOWING:
 - TAS 201-94
 - TAS 202-94
 - TAS 203-94
- ADEQUACY OF THE EXISTING STRUCTURAL CONCRETE/MASONRY, 2X FRAMING, AND METAL FRAMING AS A MAIN WIND FORCE RESISTING SYSTEM CAPABLE OF WITHSTANDING AND TRANSFERRING APPLIED PRODUCT LOADS TO THE FOUNDATION IS THE RESPONSIBILITY OF THE ENGINEER OR ARCHITECT OF RECORD FOR THE PROJECT OF INSTALLATION.
- 1X AND 2X BUCKS (WHEN USED) SHALL BE DESIGNED AND ANCHORED TO PROPERLY TRANSFER ALL LOADS TO THE STRUCTURE. BUCK DESIGN AND INSTALLATION IS THE RESPONSIBILITY OF THE ENGINEER OR ARCHITECT OF RECORD FOR THE PROJECT OF INSTALLATION.
- THE INSTALLATION DETAILS DESCRIBED HEREIN ARE GENERIC AND MAY NOT REFLECT ACTUAL CONDITIONS FOR A SPECIFIC SITE. IF SITE CONDITIONS CAUSE INSTALLATION TO DEVIATE FROM THE REQUIREMENTS DETAILED HEREIN, A LICENSED ENGINEER OR ARCHITECT SHALL PREPARE SITE SPECIFIC DOCUMENTS FOR USE WITH THIS DOCUMENT IN NON-HVHZ AREAS.
- APPROVED IMPACT PROTECTIVE SYSTEM IS **NOT REQUIRED** ON THIS PRODUCT IN AREAS REQUIRING IMPACT RESISTANCE.
- WINDOW FRAME MATERIAL: ALUMINUM 6063-T6
- GLASS MEETS THE REQUIREMENTS OF ASTM E 1300 GLASS CHARTS. SEE SHEET 1 FOR GLAZING DETAILS.

MAX. WINDOW FRAME SIZE		CONFIG.	DESIGN PRESSURE	GLASS TYPE	MISSILE IMPACT RATING
WIDTH	HEIGHT				
37"	76"	X	+80 / -80 PSF	G1/G2/G3	LARGE & SMALL MISSILE IMPACT
37"	76"	XX	+80 / -80 PSF	G1/G2/G3	
42"	90"	X	+62 / -113 PSF	G3	
42"	90"	XX	+62 / -113 PSF	G3	

TABLE OF CONTENTS	
SHEET	SHEET DESCRIPTION
1	GENERAL NOTES & GLAZING DETAILS
2	ELEVATION, ANCHOR LAYOUT, & DESIGN PRESSURE TABLE
3	ELEVATION, ANCHOR LAYOUT, & DESIGN PRESSURE TABLE
4	VERTICAL SECTIONS
5	HORIZONTAL SECTIONS
6	HORIZONTAL SECTIONS
7	INSTALLATION NOTES & ANCHOR DETAILS

TITLE: LR-420 ALUMINUM OUTSWING CASEMENT WINDOW (HVHZ) (IMPACT)
GENERAL NOTES & GLAZING DETAILS

PREPARED BY: BUILDING DROPS, INC.
398 E. DANIA BEACH BLVD., STE. 338
DANIA BEACH, FL 33004
PH: (954)399-8478
FAX: (954)744-4738
WEB: www.buildingdrops.com

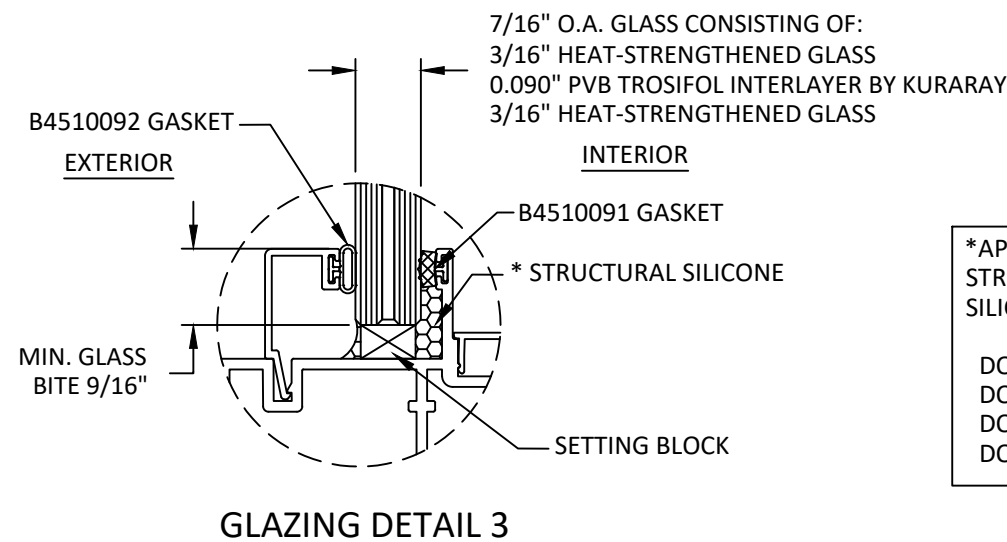
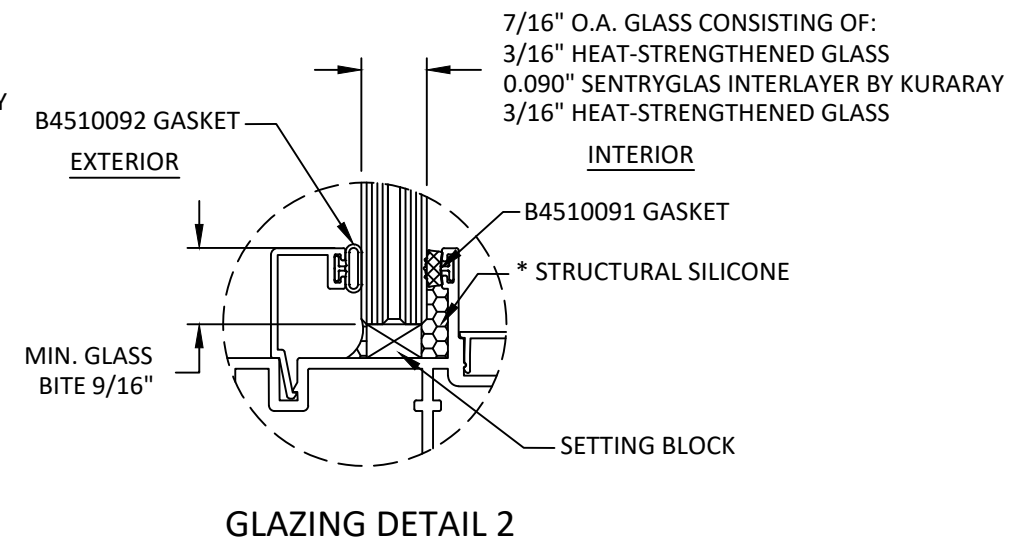
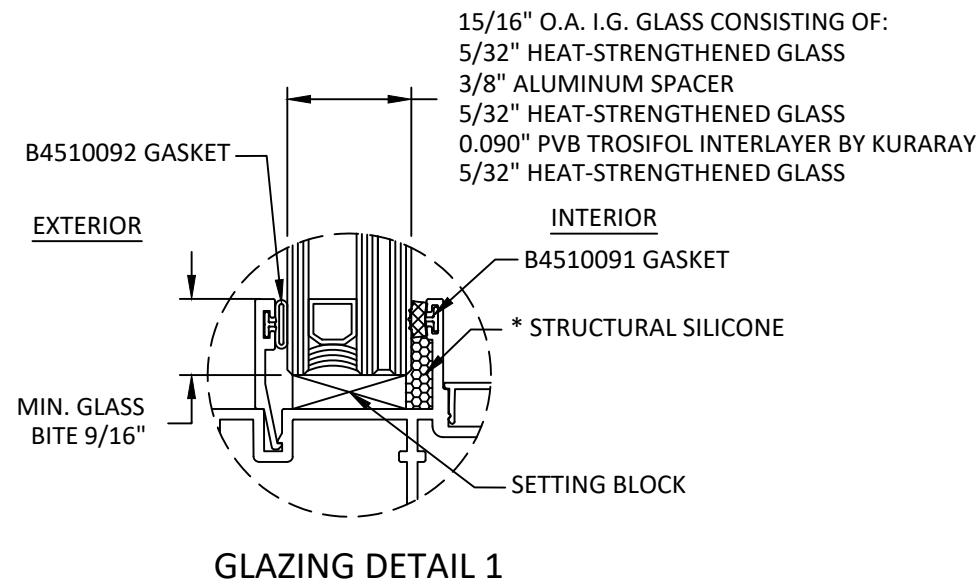

*APPROVED STRUCTURAL SILICONE:
DOWSIL - 993
DOWSIL - 983
DOWSIL - 895
DOWSIL - 795

GLAZING NOTES:

- GLASS TYPE COMPLIES WITH ASTM E1300 REQUIREMENTS. TEMPER AND SAFETY GLAZING REQUIREMENTS SHALL BE REVIEWED ON A SITE SPECIFIC BASIS.
- SACRIFICIAL LITE SHALL BE TEMPERED WHEN INSTALLED 30' OR HIGHER ABOVE GRADE IN HVHZ.
- SETTING BLOCK DUROMETER HARDNESS OF 70-90 (SHORE A) AS REFERENCED IN FBC CHAPTER 24.
- TWO APPROVED SETTING BLOCKS SHALL BE USED FOR GLASS WIDER THAN 36" AS PER FBC CHAPTER 24.
- D.L.O. AND DESIGN PRESSURES MAY NOT EXCEED MAX VALUES IN DP TABLE ON SHEET 1, AND ELEVATIONS ON SHEETS 2 & 3.

REMARKS	BY	DATE

THE INSTALLATION DETAILS DESCRIBED HEREIN ARE GENERIC AND MAY NOT REFLECT ACTUAL CONDITIONS FOR A SPECIFIC SITE. IF SITE CONDITIONS CAUSE INSTALLATION TO DEVIATE FROM THE REQUIREMENTS DETAILED HEREIN, A LICENSED ENGINEER OR ARCHITECT SHALL PREPARE SITE SPECIFIC DOCUMENTS FOR USE WITH THIS DOCUMENT.

HERMES F. NORERO P.E.
FLORIDA P. E. NO. 73778
398 E. DANIA BEACH BLVD., STE. 338
DANIA BEACH, FL 33004
FBPE CERT. OF AUTHORIZATION NO. 29578

FL39598

DATE: 10.06.2023

DWG. BY: SH CHK. BY: HFN

SCALE: NTS

DWG. #: LRA017

SHEET: 1 OF 7

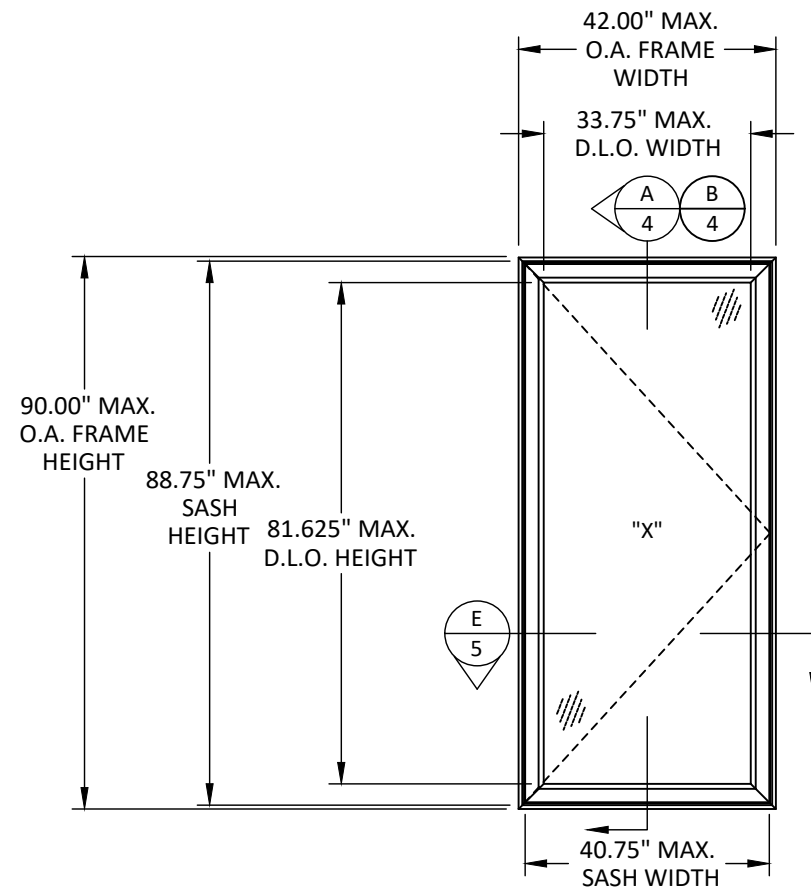

ELEVATION
SINGLE - CASEMENT WINDOW

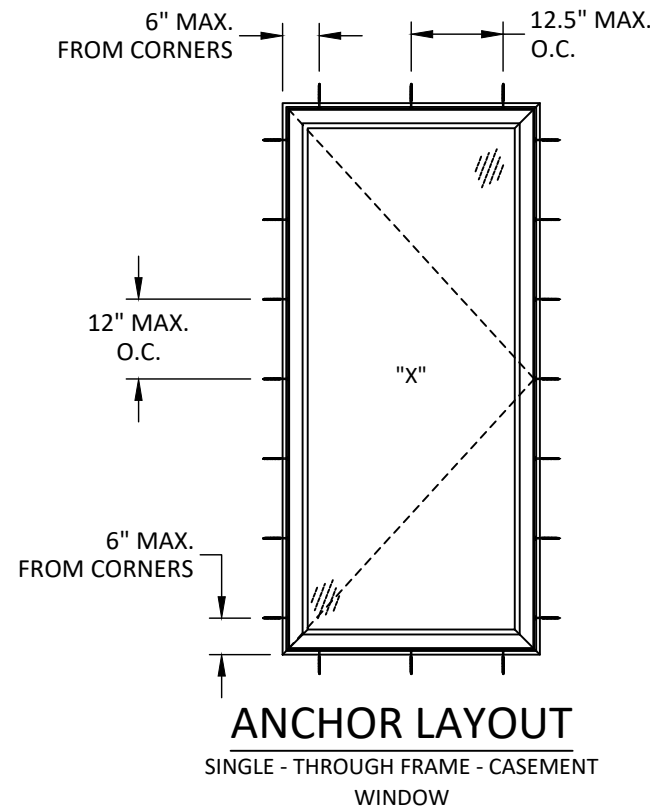

ANCHOR LAYOUT
SINGLE - THROUGH FRAME - CASEMENT WINDOW

DESIGN PRESSURE TABLE (PSF)							
WINDOW DIMENSIONS		GLAZING DETAIL					
FRAME WIDTH (IN.)	FRAME HEIGHT (IN.)	G1/G2/G3	G3				
		+/-	+	-			
37	34	80.0	62.0	113.0			
43		80.0	62.0	113.0			
49		80.0	62.0	113.0			
55		80.0	62.0	113.0			
61		80.0	62.0	113.0			
67		80.0	62.0	113.0			
73		80.0	62.0	113.0			
79		-	62.0	113.0			
85		-	62.0	113.0			
91		-	62.0	113.0			
97	-	62.0	113.0				
103	-	62.0	113.0				
109	-	62.0	113.0				
37	40	80.0	62.0	113.0			
43		74.0	62.0	113.0			
49		74.0	62.0	113.0			
55		74.0	62.0	113.0			
61		74.0	62.0	113.0			
67		74.0	62.0	113.0			
73		-	62.0	113.0			
79		-	62.0	113.0			
85		-	62.0	113.0			
91		-	62.0	113.0			
37	46	80.0	62.0	113.0			
43		68.8	60.6	110.4			
49		64.3	56.6	103.2			
55		64.3	56.6	103.2			
61		64.3	56.6	103.2			
67		-	56.6	103.2			
73		-	56.6	103.2			
79		-	56.6	103.2			
37		52	80.0	62.0	113.0		
43			68.8	60.6	110.4		
49	60.4		53.1	96.9			
55	-		50.1	91.3			
61	-		50.1	91.3			
67	-		50.1	91.3			
37	58		80.0	62.0	113.0		
43			68.8	60.6	110.4		
49			-	53.1	96.9		
55			-	47.3	86.3		
61		-	44.9	81.8			
37		64	80.0	62.0	113.0		
43			68.8	60.6	110.4		
49			-	53.1	96.9		
55			-	47.3	86.3		
37			70	80.0	62.0	113.0	
43	-			60.6	110.4		
49	-			53.1	96.9		
37	76			80.0	62.0	113.0	
43				-	60.6	110.4	
49				-	53.1	96.9	
37		82		-	62.0	113.0	
43				-	60.6	110.4	
37				90	-	62.0	113.0
42					-	62.0	113.0

TITLE: LR-420 ALUMINUM OUTSWING
CASEMENT WINDOW
(HVHZ) (IMPACT)
ELEVATION, ANCHOR LAYOUT,
& DESIGN PRESSURE TABLE

PREPARED BY: BUILDING DROPS, INC.
398 E. DANIA BEACH BLVD., STE. 338
DANIA BEACH, FL 33004
PH: (954)399-8478
FAX: (954)744-4738
WEB: www.buildingdrops.com



REMARKS	BY	DATE

THE INSTALLATION DETAILS DESCRIBED HEREIN ARE GENERIC AND MAY NOT REFLECT ACTUAL CONDITIONS FOR A SPECIFIC SITE. IF SITE CONDITIONS CAUSE INSTALLATION TO DEVIATE FROM THE REQUIREMENTS DETAILED HEREIN, A LICENSED ENGINEER OR ARCHITECT SHALL PREPARE SITE SPECIFIC DOCUMENTS FOR USE WITH THIS DOCUMENT.

HERMES F. NORERO P.E.
FLORIDA P. E. NO. 73778
398 E. DANIA BEACH BLVD., STE. 338
DANIA BEACH, FL 33004
FBPE CERT. OF AUTHORIZATION NO. 29578

FL39598

DATE: 10.06.2023

DWG. BY: SH	CHK. BY: HFN
-----------------------	------------------------

SCALE: **NTS**

DWG. #: **LRA017**

SHEET: **2** OF 7

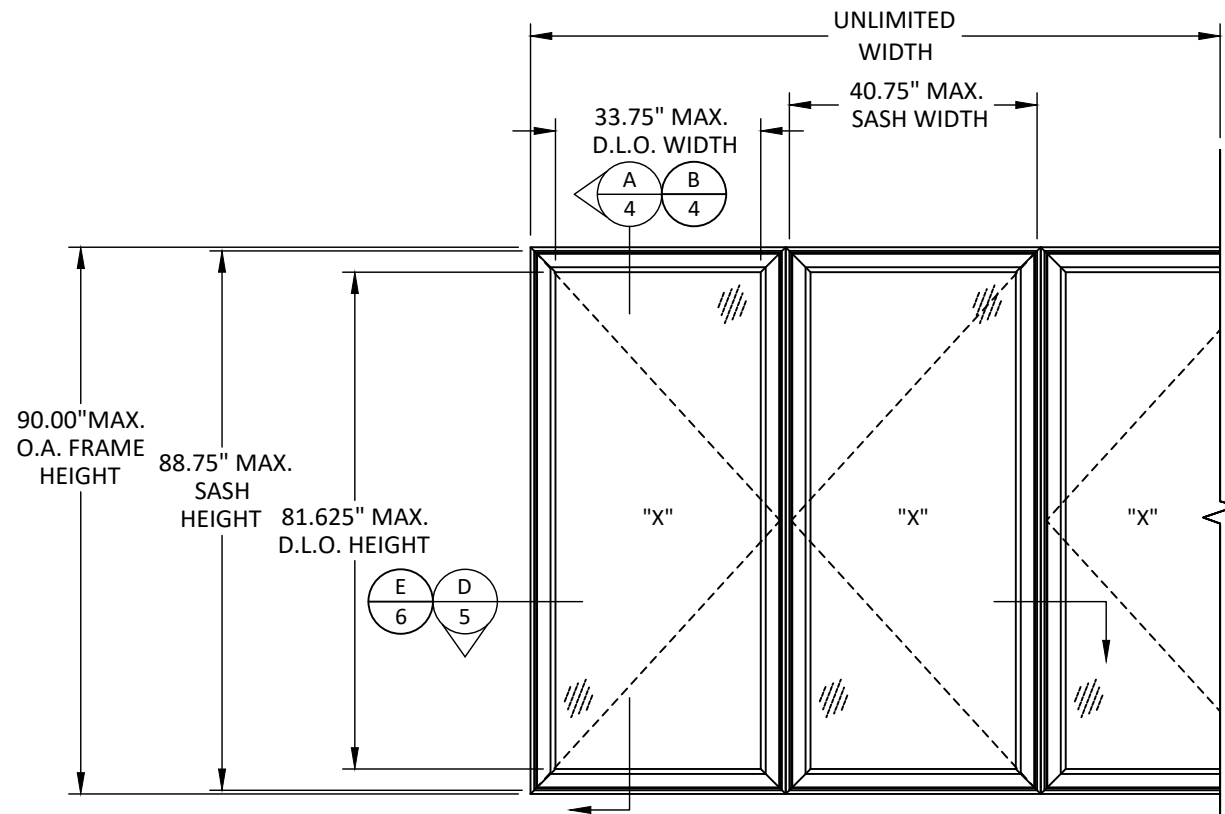

ELEVATION

MULLED - CASEMENT WINDOW

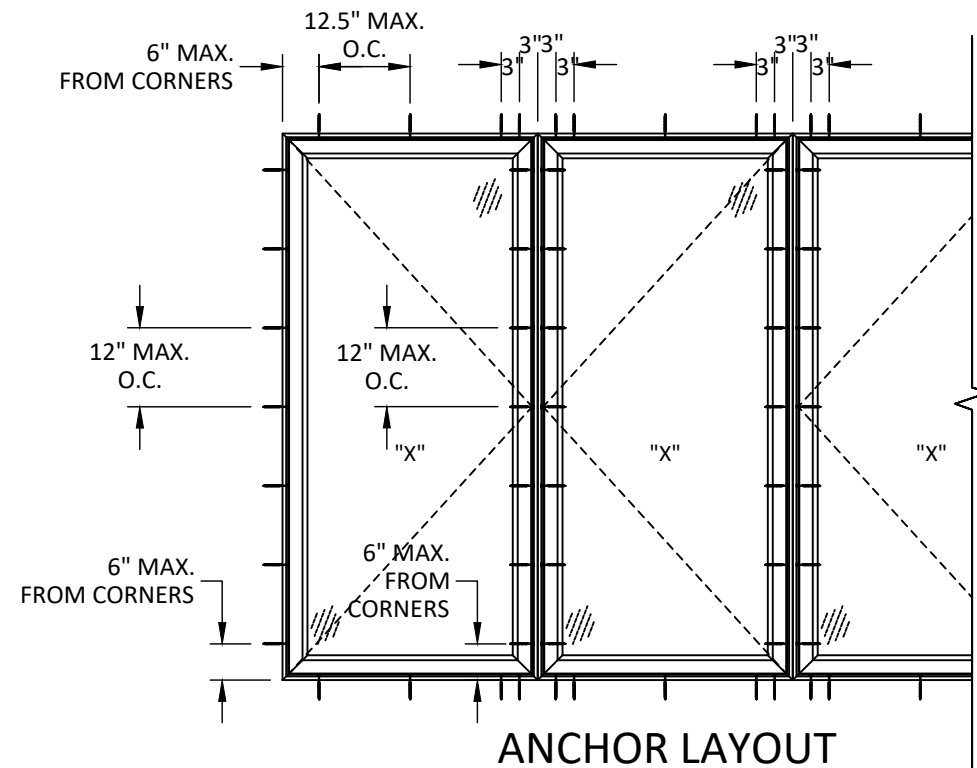

ANCHOR LAYOUT

MULLED - THROUGH FRAME - CASEMENT WINDOW

NOTE:
SINGLE WINDOW MAY BE
MULLED WITH APPROVED
TUBE MULLION SYSTEM
UNDER SEPARATE APPROVAL

DESIGN PRESSURE TABLE (PSF)							
WINDOW DIMENSIONS		MULLION TYPE					
TRIBUTARY WIDTH (IN.)	FRAME HEIGHT (IN.)	LIGHT MULLION	HEAVY MULLION				
		+/-	+	-			
37	34	80.0	62.0	113.0			
43		80.0	62.0	113.0			
49		80.0	62.0	113.0			
55		80.0	62.0	113.0			
61		80.0	62.0	113.0			
67		80.0	62.0	113.0			
73		80.0	62.0	113.0			
79		80.0	62.0	113.0			
85		-	62.0	113.0			
91		-	62.0	113.0			
97	-	62.0	113.0				
103	-	62.0	113.0				
109	-	62.0	113.0				
37	40	80.0	62.0	113.0			
43		80.0	62.0	113.0			
49		80.0	62.0	113.0			
55		80.0	62.0	113.0			
61		80.0	62.0	113.0			
67		80.0	62.0	113.0			
73		-	62.0	113.0			
79		-	62.0	113.0			
85		-	62.0	113.0			
91		-	62.0	113.0			
37	46	80.0	62.0	113.0			
43		80.0	62.0	113.0			
49		80.0	62.0	113.0			
55		80.0	62.0	113.0			
61		80.0	62.0	113.0			
67		-	62.0	113.0			
73		-	62.0	113.0			
79		-	62.0	113.0			
85		-	62.0	113.0			
91		-	62.0	113.0			
37	52	80.0	62.0	113.0			
43		80.0	62.0	113.0			
49		80.0	62.0	113.0			
55		-	62.0	113.0			
61		-	62.0	113.0			
67		-	62.0	113.0			
37		58	80.0	62.0	113.0		
43			80.0	62.0	113.0		
49			-	62.0	113.0		
55			-	62.0	113.0		
61	-		62.0	113.0			
37	64		80.0	62.0	113.0		
43			80.0	62.0	113.0		
49			-	62.0	113.0		
55			-	62.0	113.0		
37			70	80.0	62.0	113.0	
43		-		62.0	113.0		
49		-		62.0	113.0		
37		76		80.0	62.0	113.0	
43				-	62.0	113.0	
49				-	62.0	113.0	
37	82			-	62.0	113.0	
43				-	62.0	113.0	
37				90	-	62.0	113.0
43					-	62.0	113.0
37			-		62.0	113.0	
42			-		62.0	113.0	

1850 NW. 84TH AVE., STE. 114
DORAL, FL 33126
PH: (305)815-8797

TITLE: LR-420 ALUMINUM OUTSWING
CASEMENT WINDOW
(HVHZ) (IMPACT)
ELEVATION, ANCHOR LAYOUT,
& DESIGN PRESSURE TABLE

PREPARED BY: BUILDING DROPS, INC.
398 E. DANIA BEACH BLVD., STE. 338
DANIA BEACH, FL 33004
PH: (954)399-8478
FAX: (954)744-4738
WEB: www.buildingdrops.com



REMARKS	BY	DATE

THE INSTALLATION DETAILS DESCRIBED HEREIN ARE
GENERIC AND MAY NOT REFLECT ACTUAL CONDITIONS
FOR A SPECIFIC SITE. IF SITE CONDITIONS CAUSE
INSTALLATION TO DEVIATE FROM THE REQUIREMENTS
DETAILED HEREIN, A LICENSED ENGINEER OR ARCHITECT
SHALL PREPARE SITE SPECIFIC DOCUMENTS FOR USE
WITH THIS DOCUMENT.

HERMES F. NORERO P.E.
FLORIDA P. E. NO. 73778
398 E. DANIA BEACH BLVD., STE. 338
DANIA BEACH, FL 33004
FBPE CERT. OF AUTHORIZATION NO. 29578

FL39598

DATE: 10.06.2023

DWG. BY: SH
CHK. BY: HFN

SCALE: NTS

DWG. #: LRA017

SHEET: 3 OF 7

TITLE: LR-420 ALUMINUM OUTSWING
CASEMENT WINDOW
(HVHZ) (IMPACT)
VERTICAL SECTIONS

PREPARED BY: BUILDING DROPS, INC.
398 E. DANIA BEACH BLVD., STE. 338
DANIA BEACH, FL 33004
PH: (954)399-8478
FAX: (954)744-4738
WEB: www.buildingdrops.com



REMARKS	BY	DATE

THE INSTALLATION DETAILS DESCRIBED HEREIN ARE GENERIC AND MAY NOT REFLECT ACTUAL CONDITIONS FOR A SPECIFIC SITE. IF SITE CONDITIONS CAUSE INSTALLATION TO DEVIATE FROM THE REQUIREMENTS DETAILED HEREIN, A LICENSED ENGINEER OR ARCHITECT SHALL PREPARE SITE SPECIFIC DOCUMENTS FOR USE WITH THIS DOCUMENT.

HERMES F. NORERO P.E.
FLORIDA P. E. NO. 73778
398 E. DANIA BEACH BLVD., STE. 338
DANIA BEACH, FL 33004
FBPE CERT. OF AUTHORIZATION NO. 29578

FL39598

DATE: 10.06.2023

DWG. BY: SH	CHK. BY: HFN
----------------	-----------------

SCALE: NTS

DWG. #: LRA017

SHEET: OF 7

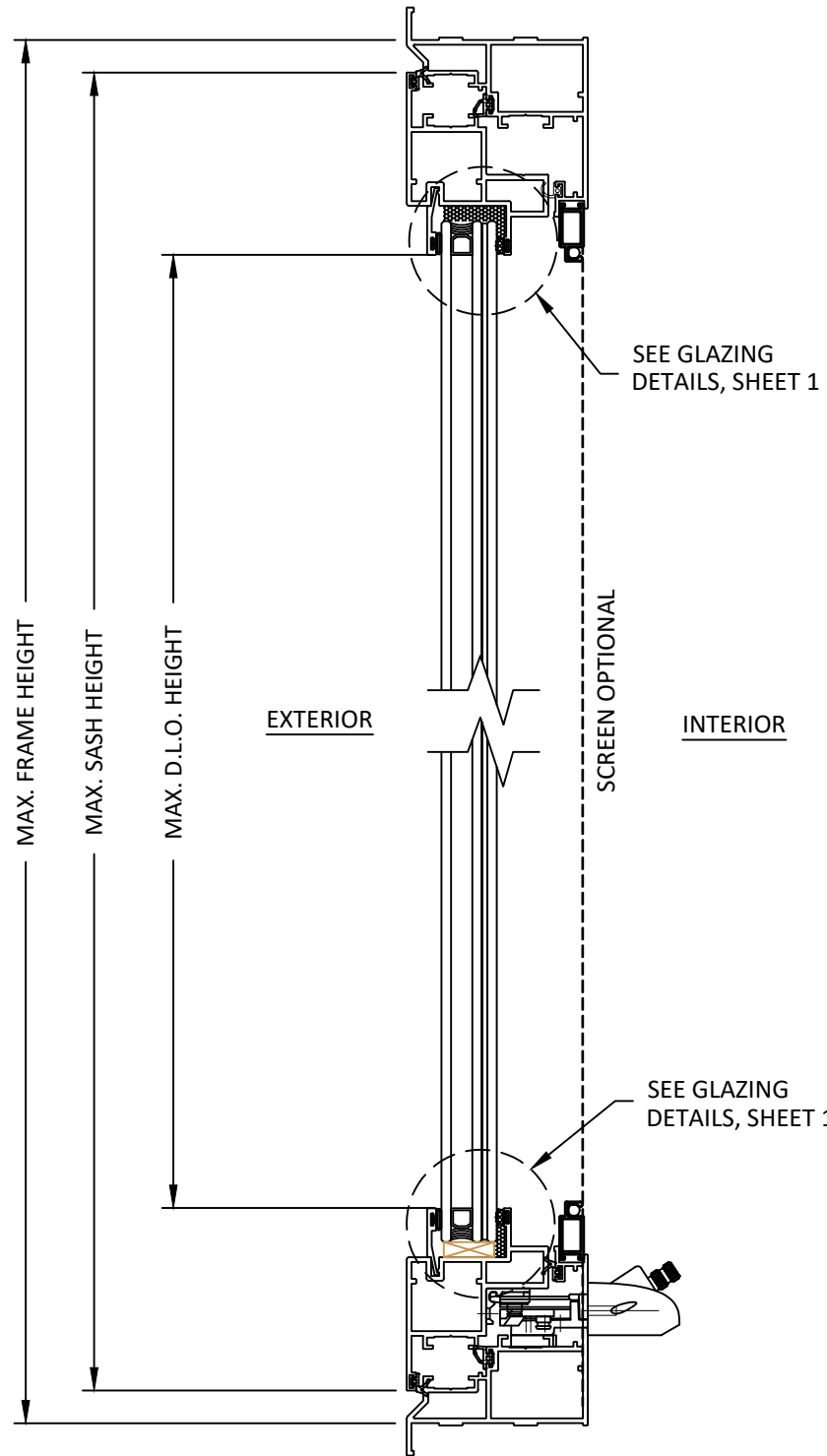

A
4
VERTICAL SECTION
SINGLE & MULLED - CASEMENT WINDOW
INSULATED GLASS

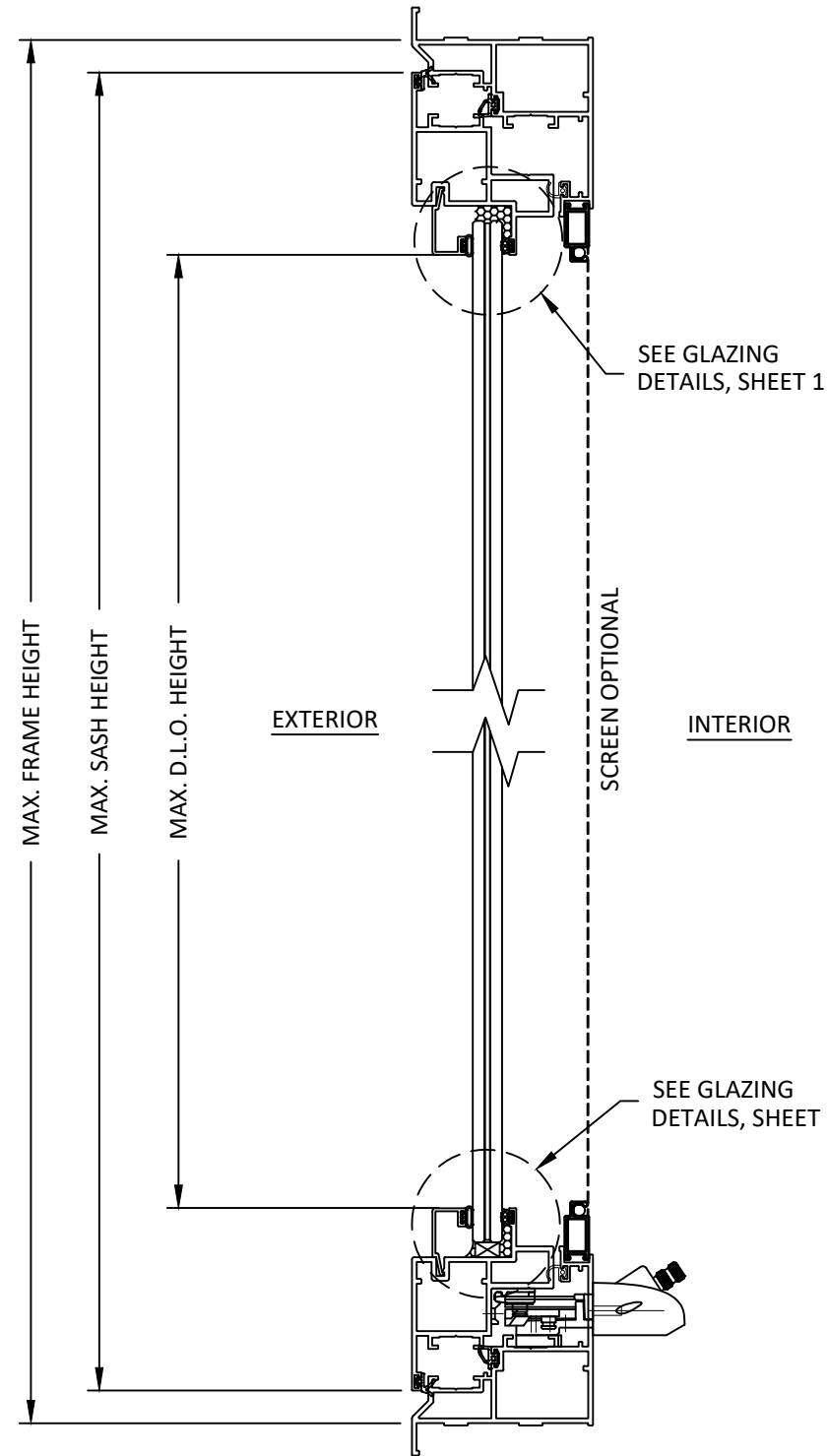

B
4
VERTICAL SECTION
SINGLE & MULLED - CASEMENT WINDOW
LAMINATED GLASS

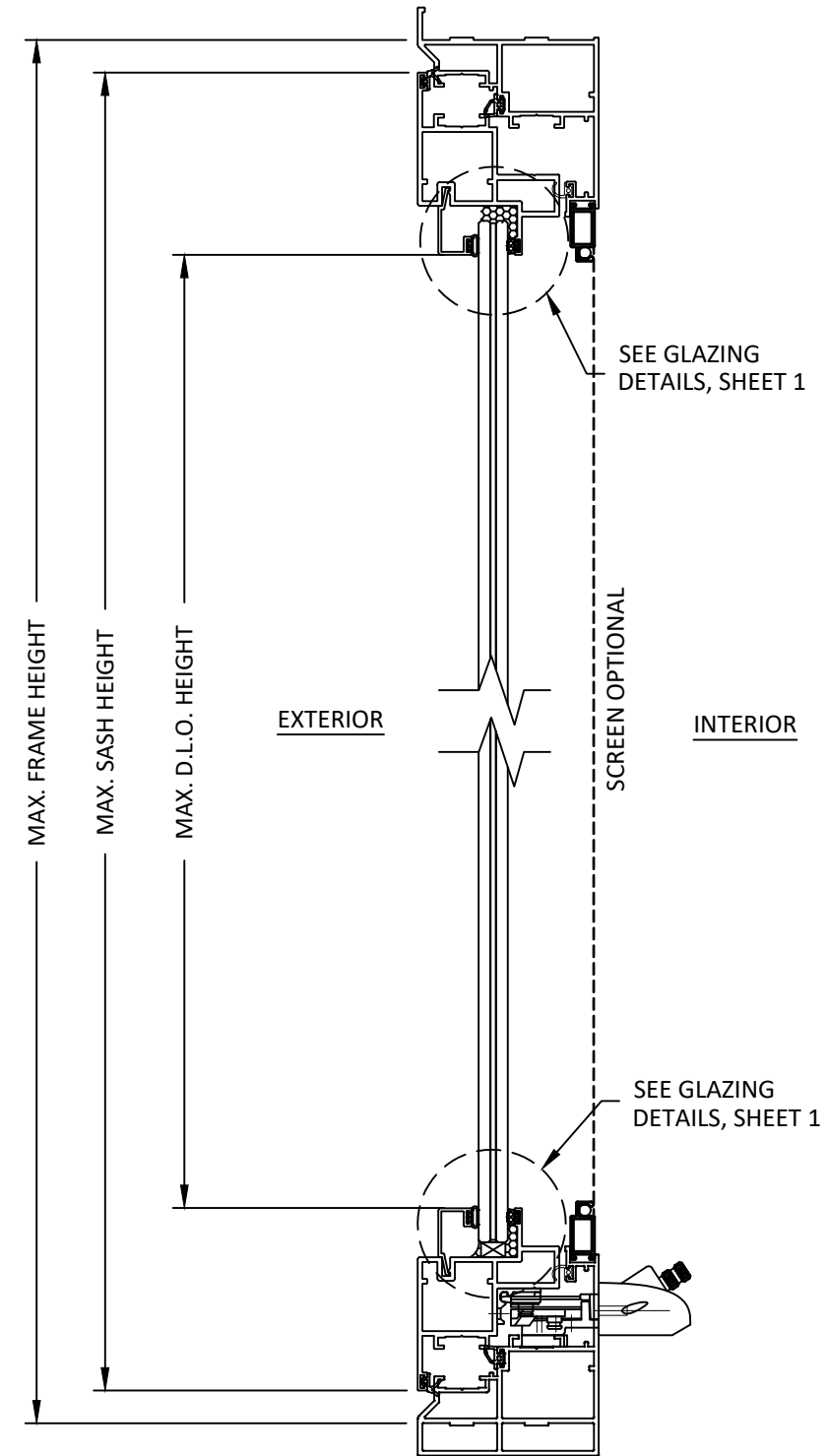

C
4
VERTICAL SECTION
SINGLE & MULLED - CASEMENT WINDOW
ALTERNATE WINDOW FRAME

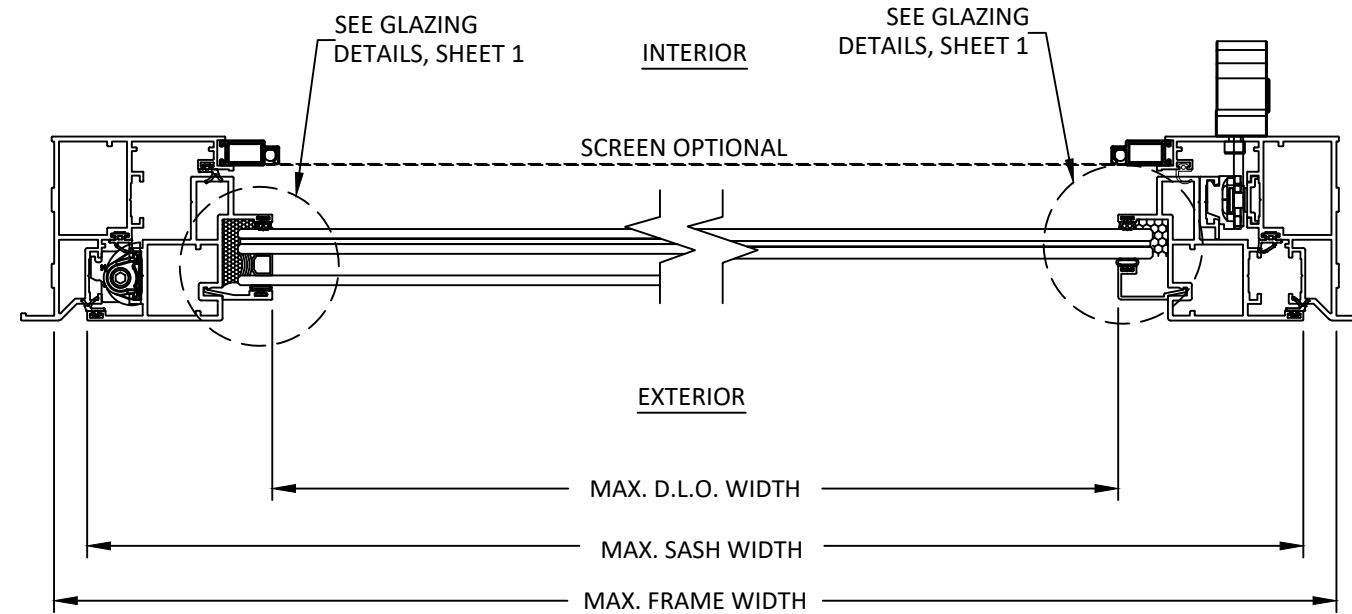

E
5 **HORIZONTAL SECTION**
SINGLE - CASEMENT WINDOW

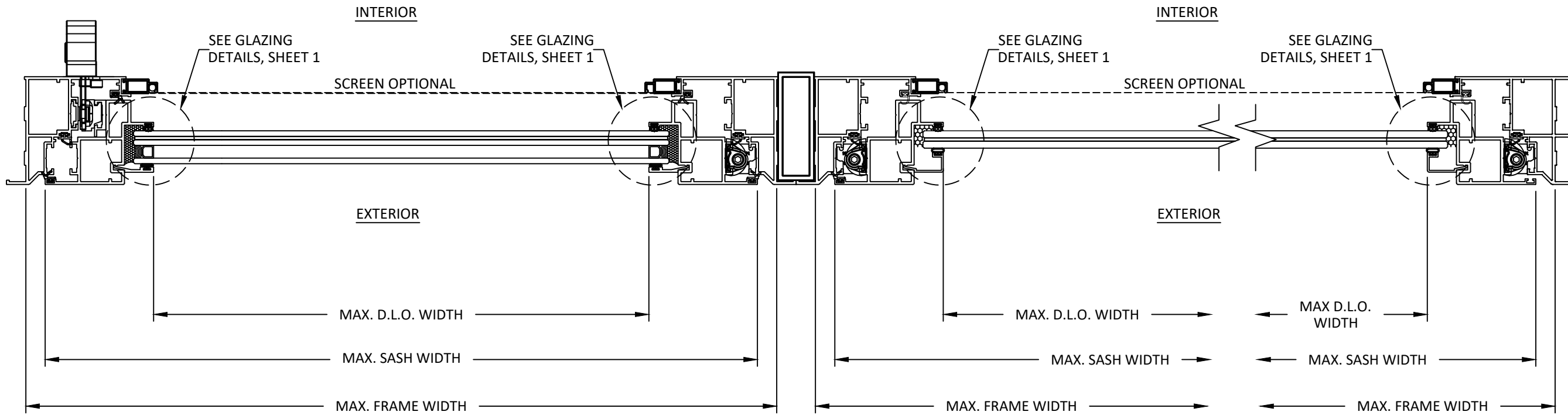

D
5 **HORIZONTAL SECTION**
LIGHT MULLED - CASEMENT WINDOW
ALTERNATE WINDOW FRAME SHOWN ON RIGHT

TITLE: LR-420 ALUMINUM OUTSWING
CASEMENT WINDOW
(HVHZ) (IMPACT)
HORIZONTAL SECTIONS

PREPARED BY: BUILDING DROPS, INC.
398 E. DANIA BEACH BLVD., STE. 338
DANIA BEACH, FL 33004
PH: (954)399-8478
FAX: (954)744-4738
WEB: www.buildingdrops.com



REMARKS	BY	DATE

THE INSTALLATION DETAILS DESCRIBED HEREIN ARE GENERIC AND MAY NOT REFLECT ACTUAL CONDITIONS FOR A SPECIFIC SITE. IF SITE CONDITIONS CAUSE INSTALLATION TO DEVIATE FROM THE REQUIREMENTS DETAILED HEREIN, A LICENSED ENGINEER OR ARCHITECT SHALL PREPARE SITE SPECIFIC DOCUMENTS FOR USE WITH THIS DOCUMENT.

HERMES F. NORERO P.E.
FLORIDA P. E. NO. 73778
398 E. DANIA BEACH BLVD., STE. 338
DANIA BEACH, FL 33004
FBPE CERT. OF AUTHORIZATION NO. 29578

FL39598

DATE: 10.06.2023

DWG. BY: SH	CHK. BY: HFN
----------------	-----------------

SCALE: NTS

DWG. #: LRA017

SHEET: 5 OF 7

TITLE: LR-420 ALUMINUM OUTSWING
CASEMENT WINDOW
(HVHZ) (IMPACT)
HORIZONTAL SECTIONS

PREPARED BY: BUILDING DROPS, INC.
398 E. DANIA BEACH BLVD., STE. 338
DANIA BEACH, FL 33004
PH: (954)399-8478
FAX: (954)744-4738
WEB: www.buildingdrops.com

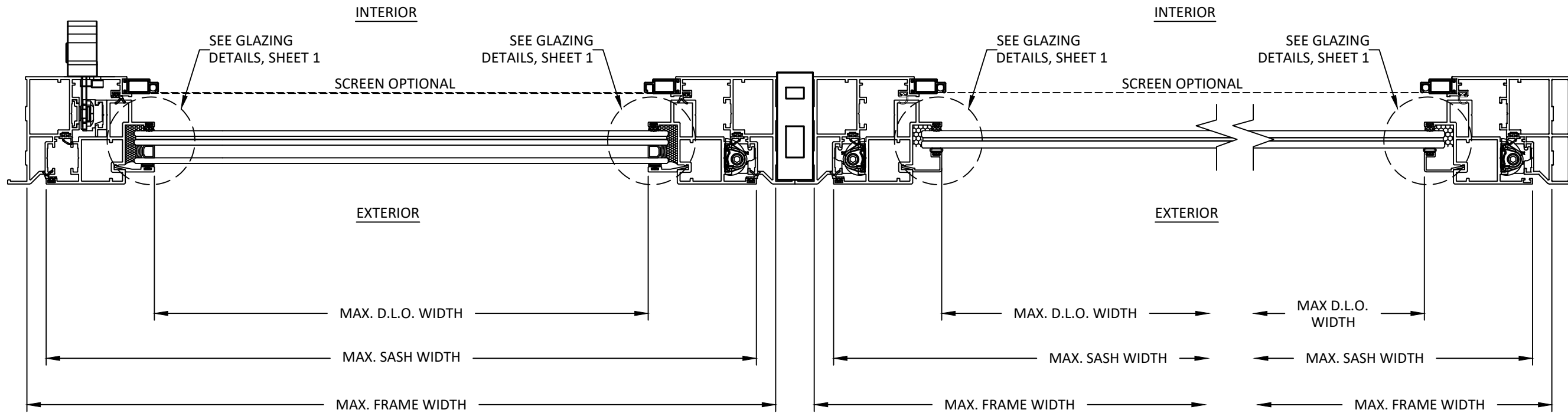

E
6 **HORIZONTAL SECTION**
HEAVY MULLED - CASEMENT WINDOW
ALTERNATE WINDOW FRAME SHOWN ON RIGHT

REMARKS	BY	DATE

THE INSTALLATION DETAILS DESCRIBED HEREIN ARE GENERIC AND MAY NOT REFLECT ACTUAL CONDITIONS FOR A SPECIFIC SITE. IF SITE CONDITIONS CAUSE INSTALLATION TO DEVIATE FROM THE REQUIREMENTS DETAILED HEREIN, A LICENSED ENGINEER OR ARCHITECT SHALL PREPARE SITE SPECIFIC DOCUMENTS FOR USE WITH THIS DOCUMENT.

HERMES F. NORERO P.E.
FLORIDA P. E. NO. 73778
398 E. DANIA BEACH BLVD., STE. 338
DANIA BEACH, FL 33004
FBPE CERT. OF AUTHORIZATION NO. 29578

FL39598

DATE: 10.06.2023

DWG. BY: SH	CHK. BY: HFN
----------------	-----------------

SCALE: NTS

DWG. #: LRA017

SHEET: 6 OF 7

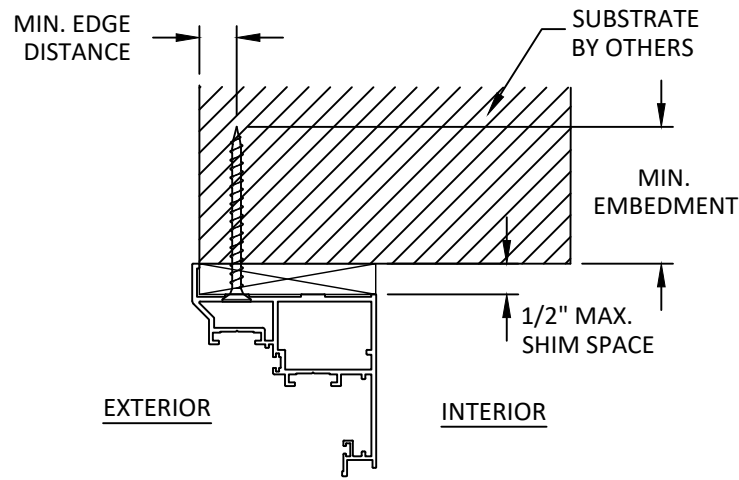

A
7 ANCHOR DETAIL
THROUGH FRAME (HEAD)

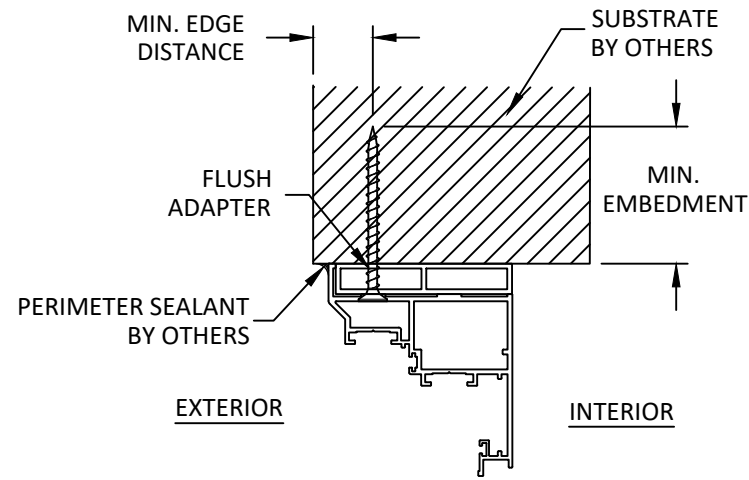

B
7 ANCHOR DETAIL
THROUGH FRAME (HEAD) W/ ALUMINUM FLUSH ADAPTER
ALTERNATE WINDOW FRAME (SIMILAR)

HEAD SHOWN,
JAMBS & SILL SIMILAR

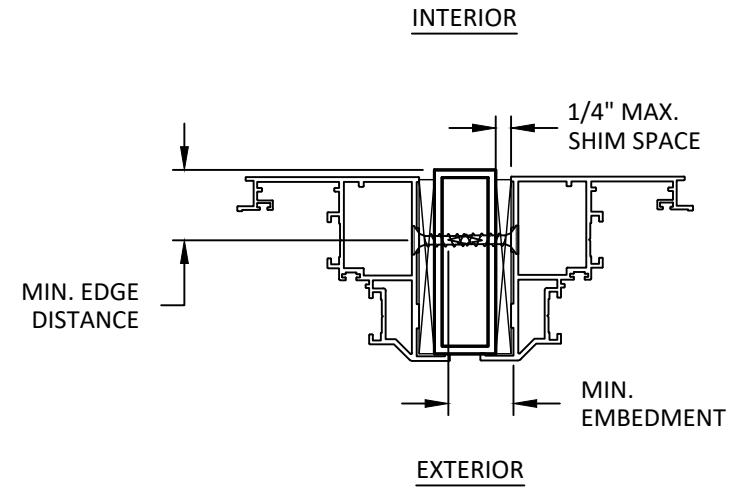

C
7 ANCHOR DETAIL
THROUGH FRAME (JAMB) MULLION

INSTALLATION NOTES:

- ONE (1) INSTALLATION ANCHOR IS REQUIRED AT EACH ANCHOR LOCATION SHOWN.
- THE NUMBER OF INSTALLATION ANCHORS DEPICTED IS THE MINIMUM NUMBER OF ANCHORS TO BE USED FOR PRODUCT INSTALLATION OF THE MAXIMUM SIZE LISTED.
- INSTALL INDIVIDUAL INSTALLATION ANCHORS WITHIN A TOLERANCE OF $\pm 1/2$ INCH THE DEPICTED LOCATION & SPACING IN THE ANCHOR LAYOUT DETAILS (I.E., WITHOUT CONSIDERATION OF TOLERANCES). TOLERANCES ARE NOT CUMULATIVE FROM ONE INSTALLATION ANCHOR TO THE NEXT.
- SHIM AS REQUIRED AT EACH INSTALLATION ANCHOR WITH LOAD BEARING SHIM(S). MAXIMUM ALLOWABLE SHIM STACK TO BE 1/2" INCH. SHIM WHERE SPACE OF 1/16 INCH OR GREATER OCCURS. SHIM(S) SHALL BE CONSTRUCTED OF HIGH DENSITY PLASTIC OR BETTER.
- FOR MASONRY OR CONCRETE OPENINGS, 1X WOOD BUCK MAY BE USED (OPTIONAL AS LONG AS THE MINIMUM EMBEDMENT AND EDGE DISTANCE REQUIREMENTS ARE STILL MET WITHIN THE CORRESPONDING HOST SUBSTRATE. SEE GENERAL NOTE #3 ON SHEET 1 FOR MORE INFORMATION.
- MINIMUM EMBEDMENT AND EDGE DISTANCE EXCLUDE WALL FINISHES, INCLUDING BUT NOT LIMITED TO STUCCO, FOAM, BRICK VENEER, AND SIDING.
- INSTALLATION ANCHORS AND ASSOCIATED HARDWARE MUST BE MADE OF CORROSION RESISTANT MATERIAL OR HAVE A CORROSION RESISTANT COATING.
- FOR HOLLOW BLOCK AND GROUT FILLED BLOCK, DO NOT INSTALL INSTALLATION ANCHORS INTO MORTAR JOINTS. EDGE DISTANCE IS MEASURED FROM FREE EDGE OF BLOCK OR EDGE OF MORTAR JOINT INTO FACE SHELL OF BLOCK.
- INSTALLATION ANCHORS SHALL BE INSTALLED IN ACCORDANCE WITH ANCHOR MANUFACTURER'S INSTALLATION INSTRUCTIONS, AND ANCHORS SHALL NOT BE USED IN SUBSTRATES WITH STRENGTHS LESS THAN THE MINIMUM STRENGTH SPECIFIED BY THE ANCHOR MANUFACTURER.

ANCHOR SCHEDULE					
METHOD	SUBSTRATE TYPE	SUBSTRATE	ANCHOR TYPE	MIN EMBEDMENT	MIN. EDGE DISTANCE
THROUGH FRAME	A	WOOD: MIN. SG = 0.55	1/4" DEWALT ULTRACON+	1.50"	1.00"
	B	METAL: 18 GAUGE STEEL, MIN. Fy = 33KSI ALUMINUM .125" MIN, 6063-T5 MIN	#14-20 DRILL FLEX GR.5	3 THREADS MIN. PENETRATION BEYOND METAL	0.75"
	C	CONCRETE: f _c =3000PSI	1/4" DEWALT ULTRACON+	1.75"	2.50"
	D	MASONRY: CMU per ASTM C90 MIN. 2000 PSI		1.75"	2.50"
MULLIONS	E	ALUMINUM 6063-T6	1 / 4" DEWALT DRILL-FLEX	3 THREADS MIN. PENETRATION BEYOND METAL	0.75"

TITLE: LR-420 ALUMINUM OUTSWING CASEMENT WINDOW (HVHZ) (IMPACT)
INSTALLATION NOTES & ANCHOR DETAILS

PREPARED BY: BUILDING DROPS, INC.
398 E. DANIA BEACH BLVD., STE. 338
DANIA BEACH, FL 33004
PH: (954)399-8478
FAX: (954)744-4738
WEB: www.buildingdrops.com



REMARKS	BY	DATE

THE INSTALLATION DETAILS DESCRIBED HEREIN ARE GENERIC AND MAY NOT REFLECT ACTUAL CONDITIONS FOR A SPECIFIC SITE. IF SITE CONDITIONS CAUSE INSTALLATION TO DEVIATE FROM THE REQUIREMENTS DETAILED HEREIN, A LICENSED ENGINEER OR ARCHITECT SHALL PREPARE SITE SPECIFIC DOCUMENTS FOR USE WITH THIS DOCUMENT.

HERMES F. NORERO P.E.
FLORIDA P. E. NO. 73778
398 E. DANIA BEACH BLVD., STE. 338
DANIA BEACH, FL 33004
FBPE CERT. OF AUTHORIZATION NO. 29578

FL39598

DATE: 10.06.2023

DWG. BY: SH
CHK. BY: HFN

SCALE: NTS

DWG. #: LRA017

SHEET: 7 OF 7